



Installer's Guide

SmartThings
integration
with TaHoma
switch



SmartThings

| **somfy.**

somfy.

Summary

SmartThings Integration with TaHoma switch	
Pre-start checklist	03
Set Up Instructions	
Link TaHoma by Somfy to SmartThings application	04
Personalise and Control Devices with SmartThings	
Edit TaHoma devices	05
Control TaHoma devices with SmartThings	05
Create personalised routines in SmartThings application	06
Unlink TaHoma from SmartThings	08
Appendix	
Available commands and actions in SmartThings application	09

SmartThings Integration with TaHoma switch

Pre-start checklist

- Ensure you have downloaded the TaHoma by Somfy application to your smartphone or tablet (compatible with iOS 11.0+ and Android 7.0+ operating systems and software versions).



- Ensure set up of TaHoma switch is complete and paired with the equipment (RTS & Zigbee 3.0) you wish to integrate and control with your Samsung SmartThings application. The TaHoma system supports up to 50 Zigbee devices and 40 RTS channels. RTS devices programmed to an RTS channel will only receive commands from the associated TaHoma switch hub.
- Ensure the TaHoma switch firmware is up to date.
- Ensure you have your TaHoma by Somfy account login details (email and password) on hand.
- Ensure you have downloaded the Samsung SmartThings application to your smartphone or tablet.



Google Play Store



iOS App Store

- Ensure your Samsung SmartThings profile set up is completed and functional. You will need the following:
 - SmartThings is powered on and connected to a network with internet
 - SmartThings iOS/Android application is up to date
 - SmartThings account credentials on hand
 - One Samsung SmartThings account per TaHoma switch hub

Set Up Instructions

1

Link TaHoma by Somfy to SmartThings

a. From the home screen, select the + icon in the top right-hand corner.

b. Select 'Add Device'

c. Under Partner devices, select 'Add'

d. Type 'Somfy' into the search bar.

Select the Somfy brand icon.

e. Select 'Window treatment'.

f. Select 'TaHoma by Somfy'.

g. Select 'Link account'

h. Enter your TaHoma by Somfy credentials (email & password).

Select 'Log in'.

i. Select 'Yes' to authorise the application.

j. Select 'Done'.

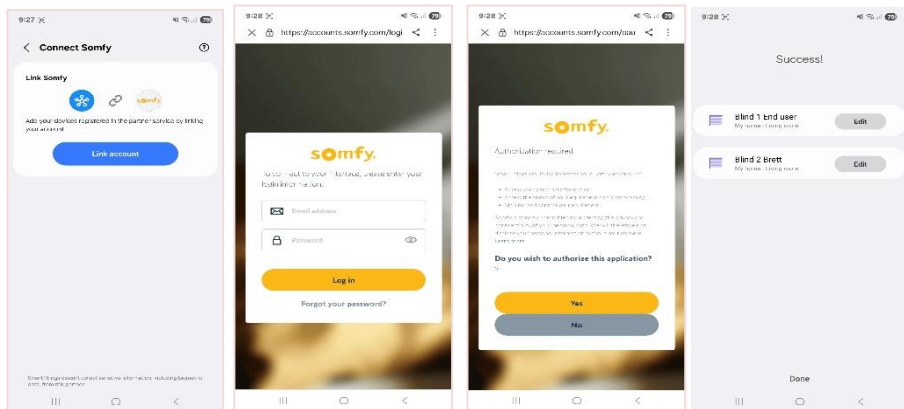
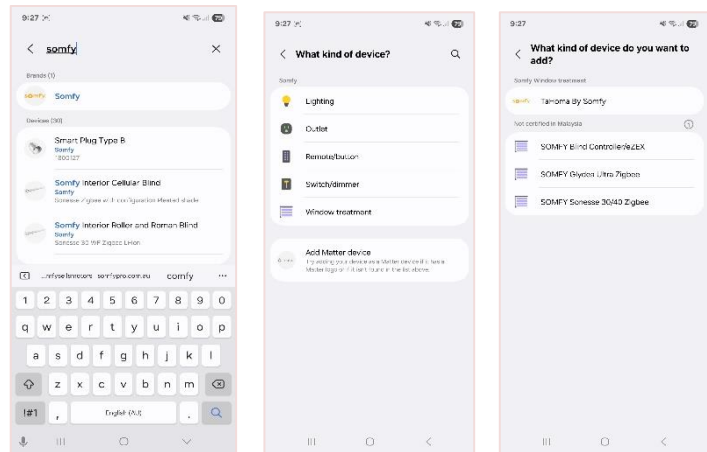
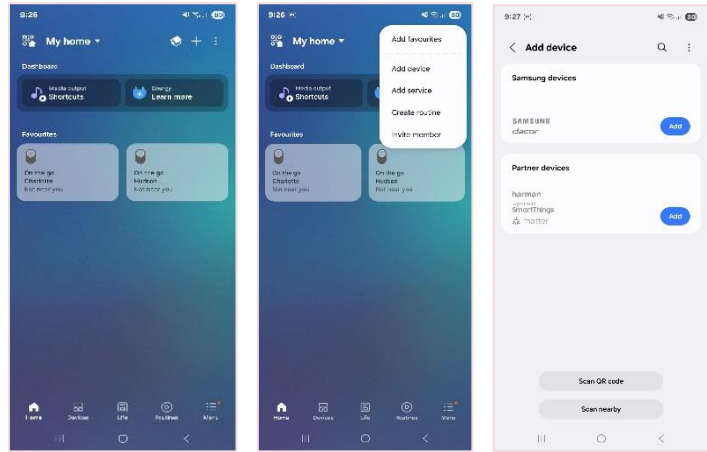

All paired devices in TaHoma will automatically appear in the room initially selected.

To disconnect TaHoma, refer to the 'Unlink TaHoma from SmartThings' section of this guide.

Personalise and Control Devices with SmartThings

2

Edit TaHoma devices

a. From the devices list, Select the device you wish to edit.

Select the options icon in the top right-hand corner.

b. Select 'Edit device' to:

- Change the room where the device is located
- Change the device name

c. Select 'Save'.

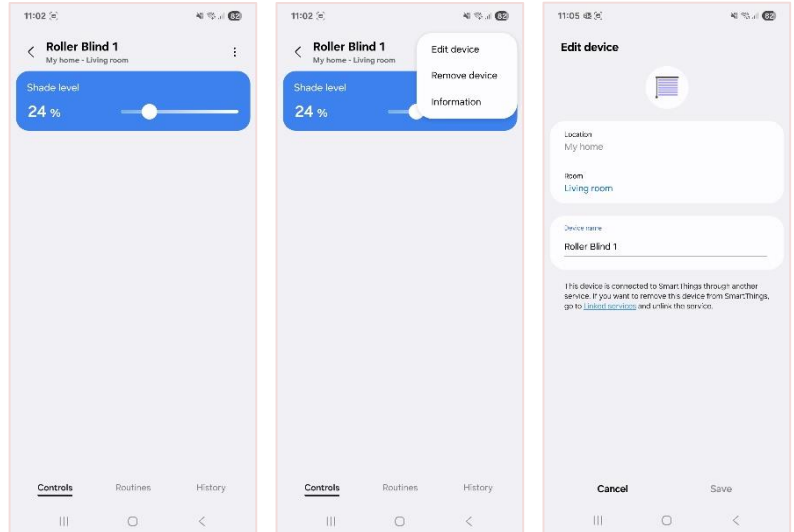

3

Control TaHoma devices with SmartThings

a. From the devices list, select the device you wish to control.

b. Select a command to control the device:

- Zigbee: Use the percentage slider
- Somfy RTS: Open & Close buttons
- Lights & Smart plugs: On/off toggle button

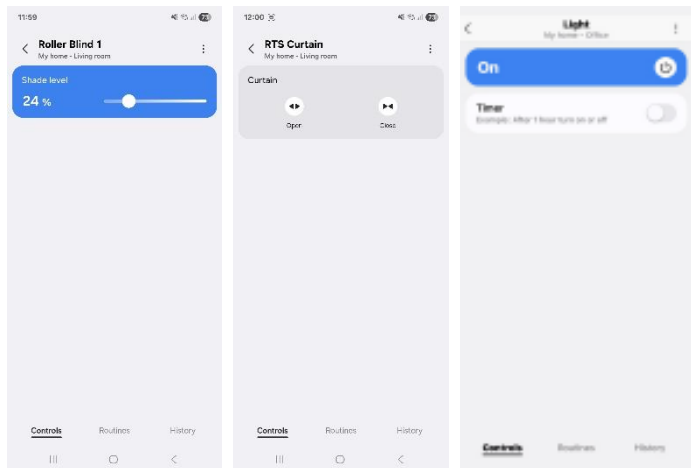

Zigbee Motor

RTS Motor

Smart Plug or Light

Control considerations:

Refer to appendix of this guide for the available commands and actions. Somfy RTS motors and equipment do not report positional feedback. SmartThings does not keep a record of the last commands sent for RTS motors. Stop or 'my' favourite position is not an available command in the SmartThings application.

Personalise and Control Devices with SmartThings

4 Create personalised routines in SmartThings application

Samsung Support suggests a limit of 250 automation behaviours per SmartThings account. Each device, condition and or action in an automation counts as a behaviour.

a. Select 'Routines'.

b. Select '+'.
c. Select '+ Add what will trigger this routine'.

Example: Roller blinds will automatically close in living room.

d. Select your preferred routine type:

- Manually run
- Time/schedule
- Device status
- Member location
- Location mode
- Weather
- Security mode

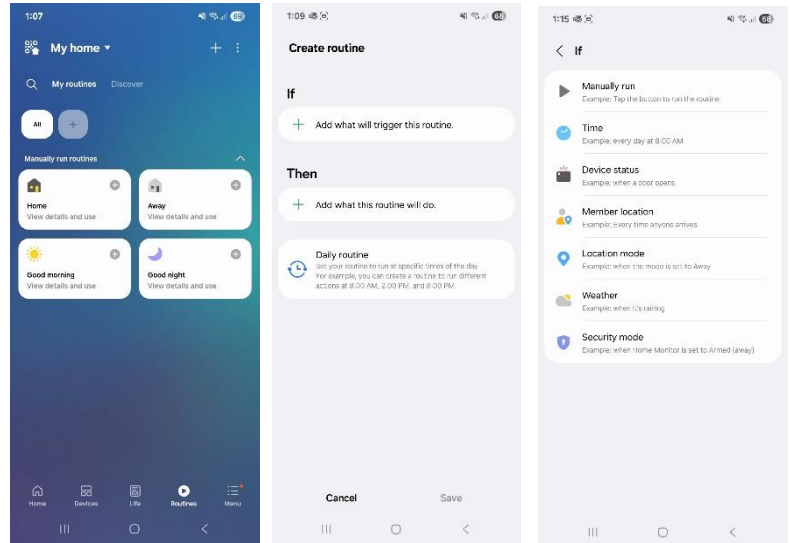

e. Select '+ Add what this routine will do'.

f. Select 'Control Devices'.

g. Select the device(s) to control:

Example: Roller Blind 1 & Roller Blind 2 in the living room.

h. Select 'Next'.

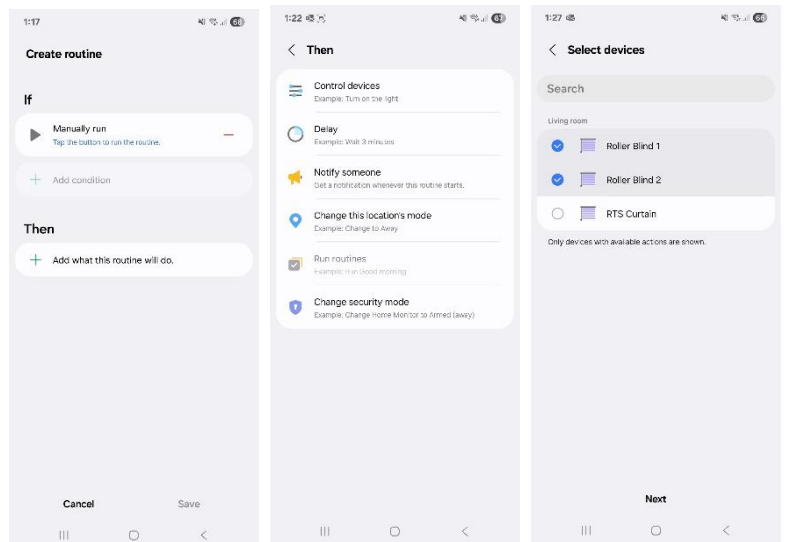

Personalise and Control Devices with SmartThings

- i. Select the individual devices to choose what each will do.
- j. Select the toggle next to 'Shade level'.
- k. Select the desired percentage level
Example: 100% closed.
- l. Select 'Done' to finalise the percentage setting.
- m. Select 'Done' to finalise the setting for the 1st device.

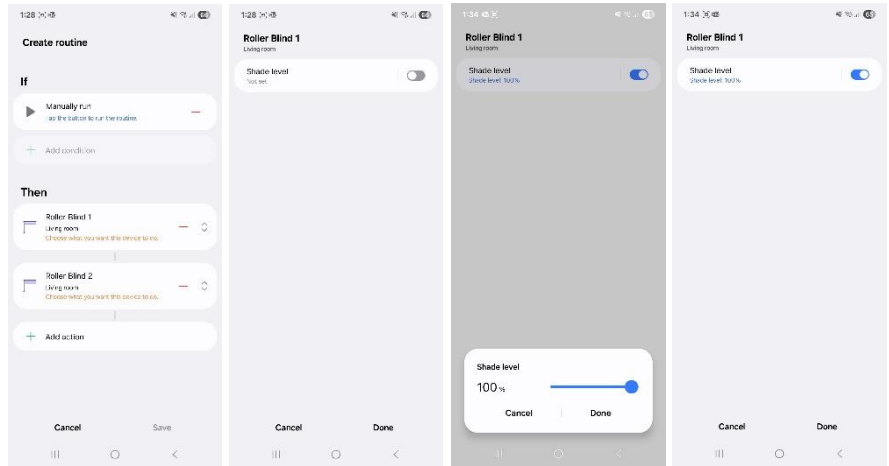

- n. Repeat steps i > m for each device.
- o. Select 'Test routine actions' to validate the actions.
- p. Select 'Save'.
- q. Enter a Routine name:
Example: Goodnight
- r. Select a Routine icon.
- s. Select Save.

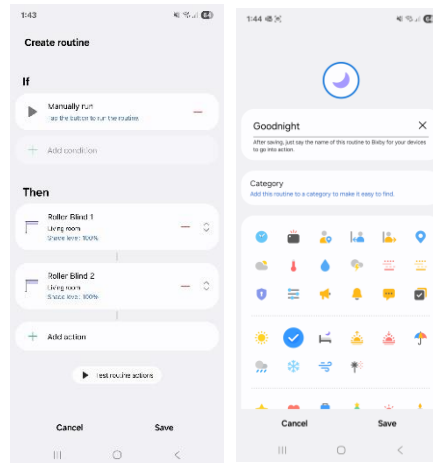

List of set routines

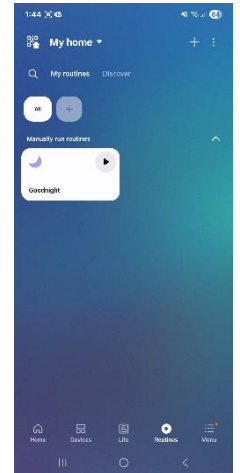

To trigger your routine, click once on the routine icon.

Unlink TaHoma from SmartThings

5

Unlink TaHoma from SmartThings

If SmartThings integration is no longer required, follow the steps to unlink. Unlinking TaHoma from SmartThings will remove all devices. Devices that were part of routines will also be removed. If relinking TaHoma, devices will need to be added back into routines.

- Select 'Menu' in the bottom right-hand corner.
- Select the setting cog in the top right-hand corner.
- Select 'Linked Services'.
- Select TaHoma by Somfy.

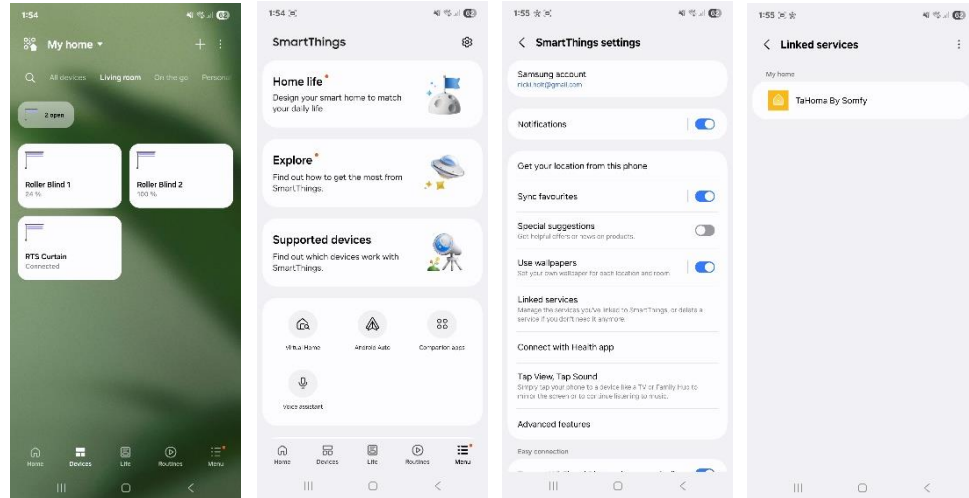

- Select 'Unlink'.
- Select 'Unlink' again, to confirm your decision.

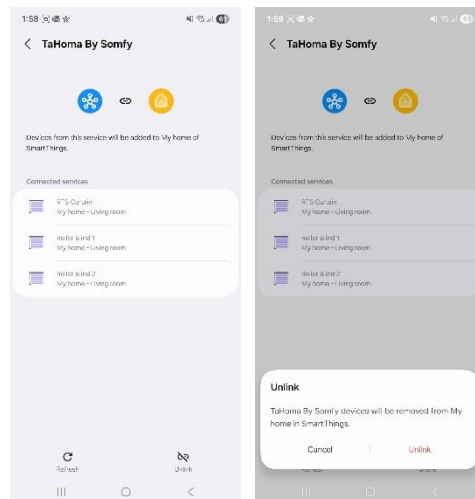

Appendix

Available commands and actions in SmartThings application



Somfy Smart Shading devices with Zigbee 3.0 Protocol

Percentage Slider	Precisely adjusts the position based on a percentage (0-100%)
Open	Moves group to the fully open position
Close	Moves group to the fully closed position



Somfy Smart Shading lighting or Philips Hue Smart Plug with Zigbee 3.0 Protocol

Off	Turns power off to the lighting device or small appliance
On	Turns power on to the lighting device or small appliance



Somfy Smart Shading lighting or Philips Hue Smart Plug with Zigbee 3.0 Protocol

Open	Moves product to the fully open position
Close	Moves product to the fully closed position
Off	Turns power off to the RTS light kit
On	Turns power on to the RTS light kit

Control considerations:

Somfy RTS motors and equipment do not report positional feedback. SmartThings does not keep a record of the last commands sent for RTS motors. Stop or 'my' favourite position is not an available command in SmartThings application.



About Somfy

For more than 50 years, Somfy has been driving durable positive motion as a pioneer in window and door automation. Developed with comfort, ease of use, security and sustainability in mind, our seamless and connective solutions are designed to help people make the move to living spaces impactful for humans and with a reduced impact on nature.

A BRAND OF **SOMFY** GROUP

Version 1: August 2025
SOMFY Pty Limited – ABN 77 003 917 244 – 20/38-46 South St,
Rydalmere NSW 2116
T +61 (0)2 8845 7200 – somfy.au@somfy.com