

**TaHoma® switch**

Smart Control System

The smart control system to centralise and connect your home equipment.

## PRODUCTS MAIN FUNCTIONALITIES



**Natively connects via WiFi** with option to connect via ethernet using an adaptor



**Open and scalable** smart control system that can be integrated with other smart products



**Create scenes**

up to 40 standard scenes, 20 timed scenes and 20 advanced scenes



**Centralised control using voice or app** when paired with compatible smart devices



**Activate two routines** from the top of the hub for simple control



**Battery level monitor**

bi-directional feedback for Somfy Zigbee motors & equipment



**Convenient control** whether you're home or away



**TaHoma pro app and Serv-e-Go pro tool** for onsite/offsite installation and maintenance



**somfy.**

## COMPATIBLE END PRODUCTS

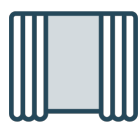

Curtains



Shutters



Roman Blinds



Roller Blinds



Zebra



Cellular & Pleated



Awnings



Philips Hue Lighting (on/off)<sup>1</sup>



Philips Hue Smart Plug (on/off)



Somfy Izymo on/off receiver



Somfy Izymo motor receiver



Selected Zigbee 3.0 products<sup>2</sup>

**TaHoma® switch**

Smart Control System

## BENEFITS FOR PROFESSIONALS

### Intuitive and easy to install and setup

- Step-by-step instructions within the application to support a seamless and efficient hub setup.
- Installer TaHoma pro app and Serv-e-Go tools available for error free pre-setup, as well as efficient onsite or offsite installation and maintenance.
- Natively connects via WiFi with option to connect via ethernet cable (*adaptor required, sold separately*).

## BOX INCLUSIONS

- 1 x TaHoma switch hub
- 1 x USB power adaptor
- 1 x USB power cable
- 1 x legal security notice
- 1 x TaHoma switch setup leaflet
- 1 x Apple HomeKit setup leaflet

## ITEM NUMBERS

**TaHoma switch hub** 1871147

**Ethernet adaptor for TaHoma switch (*optional extra*)** 9028054

Front View



Top View



Side View



USB power cable



USB power adaptor



Ethernet adaptor (*optional extra, data cable not included*)

## BENEFITS FOR END USERS

### Open and scalable control systems

- Can be integrated with Somfy and other leading third-party Zigbee 3.0 products<sup>2</sup>.
- Voice control with Amazon Alexa, Google Home, and Apple HomeKit<sup>3</sup>.
- Centralised control via an app or voice control.
- Capable of controlling up to 125 end products (*comprising of Somfy RTS devices and compatible Zigbee 3.0 devices*).

### Smart, intuitive and easy to use

- Bi-directional feedback, battery level monitoring for Somfy Zigbee motors & compatible products.
- Convenient control whether you are home or away.
- Set up a variety of scenes and scheduled timers to create your ideal ambience, simplify your daily routines and personalise your environment.

## DIMENSIONS OF THE HUB

**L1** 162mm

**L2** 67mm

**L3** 35mm

<sup>1</sup> Requires a Philips Hue bridge.

<sup>2</sup> Refer to partnerships and compatibilities on page 3.

<sup>3</sup> Apple HomeKit connectivity only via TaHoma switch and Somfy Zigbee devices.

## TAHOMA SWITCH FUNCTIONS & CAPABILITIES

	Maximum
<b>Number of Zigbee 3.0 products per hub<sup>5</sup></b>	60 actuators <sup>4</sup> and 15 Ysia controls
<b>Number of Somfy RTS products per hub</b>	50
<b>Number of manual scenes per hub</b>	40
<b>Number of customised scenes</b> (controlled through the scene launcher push buttons)	2
<b>Number of advanced scenes per hub</b> (which incorporate Zigbee 3.0 sensors)	20
<b>Number of timers/scheduled scenes</b> (including sunrise and sunset functions)	20
<b>Number of hubs per profile</b>	1
<b>Number of TaHoma profiles</b> (accessible via the app without logging off)	3
<b>Voice control compatibility</b>	Google Assistant, Amazon Alexa, Apple HomeKit <sup>3</sup>
<b>Philips Hue Lighting<sup>1</sup></b>	1 bridge and 50 lamps
<b>Sonos</b>	1 account and 200 devices
<b>Languages</b>	24 languages (refer to TaHoma by Somfy app)

### Applications and systems



## TECHNICAL SPECIFICATIONS HUB

<b>Frequency &amp; Protocols</b>	Zigbee 3.0 [2.4GHz] Somfy RTS [433 MHz] Wi-Fi [2.4GHz]
<b>Power</b>	2A at 5V
<b>IP Rating</b>	IP30 (indoor use only)
<b>Power Supply</b>	230V
<b>Working Temperature</b>	0°C to 40°C
<b>RCM Compliance</b>	RCM & EESS certification
<b>Range</b> (open field)	7m for Zigbee 3.0 protocol <sup>6</sup> 200m for Somfy RTS <sup>6</sup>
<b>Compatible Operating Software</b>	iOS version: 13 or greater Android version: 9.0 or greater
<b>Devices</b>	Compatible with smartphones and tablets

### Voice Assistant Compatibility



Apple HomeKit connectivity only via TaHoma switch and Somfy Zigbee devices.

## PARTNERSHIPS AND COMPATIBILITIES<sup>7</sup>



## COMPATIBLE HOME AUTOMATION SYSTEMS<sup>7</sup>



<sup>1</sup> Requires a Philips Hue bridge.

<sup>3</sup> Apple HomeKit connectivity only via TaHoma switch and Somfy Zigbee devices.

<sup>4</sup> Actuators include Somfy Zigbee motors, Somfy Izyzo Zigbee receiver and Philips Hue smart plug. Can accommodate max. 50 WireFree Somfy Zigbee motors.

<sup>5</sup> Maximum 6 Zigbee end-products can be paired to a TaHoma switch where there is no Zigbee repeater. End-products include Somfy Zigbee WireFree motors and Ysia remote controls.

<sup>6</sup> Maximum of 7m range if no Zigbee repeaters are present within the ecosystem. The TaHoma switch is a controller and does not function as a repeater to extend the radio range of a product. Somfy RTS has a 20m range through two concrete walls or 200m in open field.

<sup>7</sup> Somfy products are compatible with many smart home partners and home automation systems. Consultation with 3rd party control systems is recommended.

## DETAILED FUNCTIONING

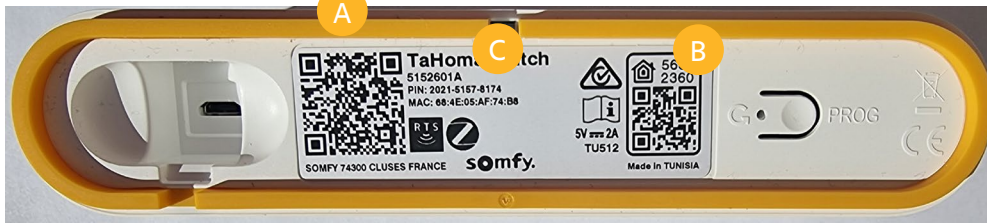

- A** QR Code links to the TaHoma switch unique PIN
- B** QR Code for quick-start pairing and set up to 'Apple HomeKit' (where applicable)
- C** TaHoma switch hub unique box PIN to support hub identification and troubleshooting

## CONNECTIONS AND INDICATORS



### TOP LED

Scene Status	Indicator Colour/ State	Duration
WiFi research WiFi lost	Blinking white 2 times Blinking 1 time	
Standby	Off	
Scene launched	Slow blinking white	3 sec.
Scene stopped (via stop button)	Solid red	<1 sec.

Top indicator is used for **SCENE MANAGEMENT**.

The top indicators are also used:

- For WiFi setting process (blinking blue) + connection outage (blinking red)
- As a restart indicator (orange)
- As an indicator for TaHoma pro mode activation, using the new TaHoma pro app (green)

### BOTTOM LED

Scene Status	Indicator Colour/ State	Duration
Box not powered	None	Off
Box powered and not connected to server	Red	Solid on
Box powered and connected to server	White	Solid on (can be deactivated)

**STANDARD** use for power and server connection status

## SETTING UP TAHOMA SWITCH WITH ETHERNET ADAPTOR (optional extra, sold separately)

The TaHoma Ethernet Adaptor [9028054] adds an ethernet LAN port to a TaHoma hub, providing a fast and stable internet connection. Ethernet cable is not included.



### TECHNICAL SPECIFICATIONS

<b>Input Power</b>	Micro USB Female: 5V, 2A (max)
<b>Output Power</b>	Micro USB Male: 5V, 2A (max)
<b>Number of Ports</b>	(Downlink Port) RJ45 + Micro B Female (Uplink Port) RJ45 + Micro B Male
<b>Transmission Speed</b>	10/100Mbps
<b>Working Temperature</b>	0°C to 60°C
<b>Dimensions (mm)</b>	H: 186.94, L: 35.31, W: 17.02

### WIRING INSTRUCTIONS

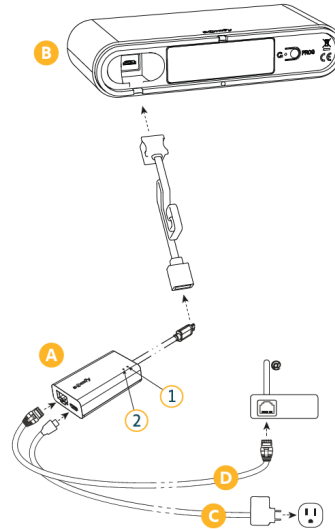

- A** Ethernet adaptor
- 1** Yellow light indicates data transfer
- 2** Blue light indicates ethernet connection
- B** TaHoma switch
- C** USB power supply
- D** Ethernet cable (not included)

### NAVIGATING TAHOMA SWITCH END USER APP<sup>8</sup>

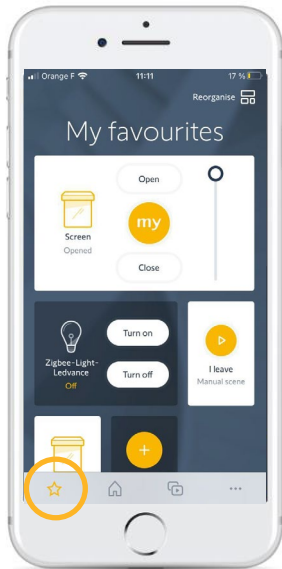

#### My Favourites

Centralise all your favourite motorised solutions, rooms or scenes on 1 tab. Customise the display and functions of each of your shortcuts to build a personalised menu.

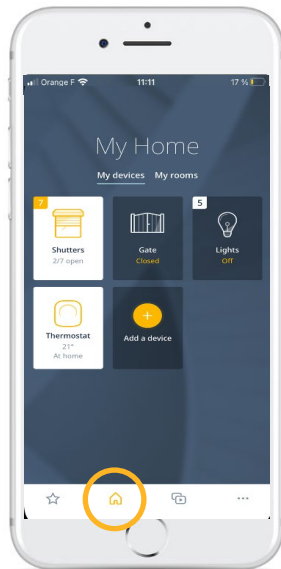

#### My Home

Access and operate all your equipment in a centralised tab in just one click. Operate your equipment by device or by room; the choice is yours.

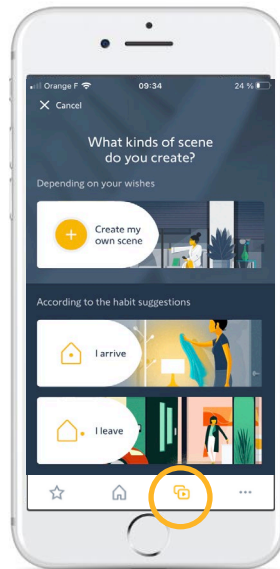

#### My Scenes

Personalise your home by creating scenes to create your ideal ambience or to save you time. Launch your scene in one click, or program a scene according to your routines and habits (schedule/timers).

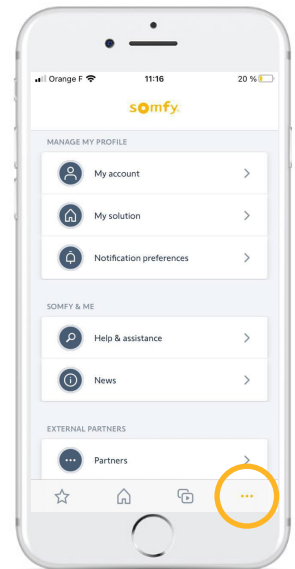

#### More

Access and manage general settings, preferences, third-party integrations and find my installer details.

<sup>8</sup>TaHoma by Somfy app navigation is subject to updates and may change. Please ensure that you are using the latest version of the app.

## INSTALLATION GUIDES AND TOOLS



**TaHoma by Somfy**  
(End-user application)

The only application that guides installers step-by-step when commissioning all Somfy products and lets them do without a paper manual, whatever the configuration they are working on.



## TAHOMA SWITCH PRE-INSTALL CHECKLIST

### For a seamless setup, please ensure:

- All Somfy (RTS and Zigbee) motors and compatible equipment are fully charged.
- Somfy RTS motor set-up is complete – pair remote controls, set motor end-limits and 'my' position.
- Your internet router is active and operational (TaHoma® switch only operates with 2.4GHz (4G) WiFi).
- WiFi network must be private/secured with a password.
- An active email address is used to create a TaHoma® switch account. It cannot be the same email address used with an existing Connexoon Window RTS account.
- You have downloaded and set up an account with all third-party compatible applications on your smart device.
- For Zigbee devices, have your motor and Ysia control QR code ready prior to pairing your Zigbee motor, TaHoma® switch and motor limit settings.

### Installation tip for building a Zigbee mesh network:

- Pair any plugs/wired Zigbee motors first. Then set up WireFree Zigbee motors, followed by any remotes.

## TROUBLESHOOTING

<b>Where can I find my TaHoma switch PIN</b>	On the underside of your TaHoma switch hub. Refer to diagram on page 4.
<b>How can I log out of my TaHoma account?</b>	Click on the 'more' tab, scroll to the bottom, select log out/disconnect. <i>Note: if you log out of the TaHoma app, your 'favourites' settings will not be saved.</i>
<b>How can I add another registered TaHoma email address?</b>	Click on the 'more' tab, select 'add facility'. Follow the instructions/prompts.
<b>My TaHoma hub has lost WiFi internet connection. How can I re-configure the WiFi internet connection?</b>	Hold the 'stop' push button on the top of your TaHoma hub until the LED light blinks blue. Go to the 'more' tab in your TaHoma app. Select 'configuration of the installation'. Select 'My installation hub'. Select 'Configure WiFi'. Choose the WiFi network (ensuring the WiFi internet is 2.4GHz (4G)), enter the WiFi password. Note: an app update maybe required/prompted.