



# Guide

INSTALLATION & USER

 ENGLISH



TaHoma®



# Connect me

...YOU WILL SOON BE ABLE TO ENJOY  
YOUR CONNECTED HOME!

# TaHoma® *serenity*

## Your simple, adaptable connected alarm



### My security

Monitor your home remotely & receive alerts by smartphone.



### My home

Connect lights, shutters, gates & much more!  
> The TaHoma® advantage

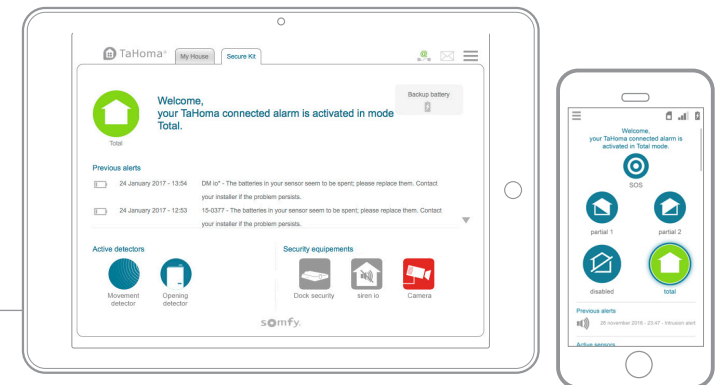

### Evolutive

Add detectors, siren & other accessories to expand your system at your pace.

**Compatible with a wide range of devices from Somfy and its partners.**

See the list at [somfy.com](http://somfy.com)

# Easy to use



Somfy assists you in installing and using TaHoma® *serenity*.

## Our video tutorials give you step-by-step guidance!

They are identified throughout the guide by this icon:



## [ Interactive guide ]

You can **click on the tutorial icon to open the video directly.**



List of video tutorials:

### GENERAL

 **Tutorial #1** Adding devices to TaHoma®

### MY SECURITY

 **Tutorial #5** Configuring the connected alarm

 **Tutorial #6** Controlling the connected alarm + Alerts

### + MY HOME

 **Tutorial #2** Creating your home in TaHoma®

 **Tutorial #3** Creating your programmes: Scenarios

 **Tutorial #4** Creating your programmes: Smart

### Need help?

Find support and a user forum on [somfy.com](https://www.somfy.com)

# Contents

## [ Interactive guide ]

You can click each title to go straight to that section



|  |           |  |           |
|--|-----------|--|-----------|
| Security products                                    | 6         | <b>ENHANCED CONNECTION WITH TAHOMA®</b>            | <b>40</b> |
| Overview of the box                                  | 7         | Your TaHoma® box is also a connected home solution | 41        |
| Accessing TaHoma®                                    | 8         | <b>INSTALLATION</b>                                | <b>43</b> |
| Warnings   | 9         | Installation steps                                 | 44        |
| <b>INSTALLATION</b>                                  | <b>10</b> | <b>1. ADD DEVICES</b>                              | <b>45</b> |
| Installation steps                                   | 11        | <b>2. CONFIGURE YOUR HOME</b>                      | <b>46</b> |
| <b>1. CONNECT THE BOX</b>                            | <b>12</b> | <b>USE</b>   | <b>47</b> |
| <b>2. CREATE YOUR ACCOUNT</b>                        | <b>13</b> | Overview of the interface                          | 48        |
| <b>3. CONFIGURE THE BOX AND ACCESSORIES</b>          | <b>14</b> | Use cases  | 50        |
| 3.1 Add security accessories                         | 16        | <b>1. CONTROL YOUR DEVICES</b>                     | <b>51</b> |
| 3.2 Configure security                               | 19        | 1.1 Example devices and icons                      | 52        |
| <b>USE</b>   | <b>27</b> | 1.2 Control your devices in real time              | 53        |
| Overview of the interface                            | 28        | 1.3 Monitor your sensors                           | 54        |
| Use cases  | 32        | 1.4 Store your favourite devices                   | 55        |
| <b>1. CONTROL SECURITY</b>                           | <b>33</b> | <b>2. CREATE YOUR CUSTOMISED PROGRAMMES</b>        | <b>56</b> |
| 1.1 Activate a security mode                         | 33        | 2.1 Scenarios                                      | 57        |
| 1.2 Real-time security status information            | 34        | 2.2 Schedule                                       | 59        |
| 1.3 Deactivate security                              | 35        | 2.3 Smart  | 63        |
| <b>2. ALERTS IN THE EVENT OF AN INTRUSION OR SOS</b> | <b>36</b> | <b>3. A FEW EXTRAS</b>                             | <b>66</b> |
| 2.1 Overall view in the event of an intrusion        | 36        | 3.1 The touch-sensor button on the box             | 66        |
| 2.2 Alert screen                                     | 37        | 3.2 Dashboard and monitoring                       | 67        |
| 2.3 Video alert screen                               | 38        | 3.3 Your account & your box                        | 68        |
| 2.4 In the event of an SOS                           | 39        | 3.4 Your account & your box                        | 69        |
|  |           | 3.5 For an even more practical security solution   | 71        |
|  |           | <b>ADDITIONAL INFORMATION</b>                      | <b>72</b> |
|  |           | Safety instructions                                | 73        |
|  |           | Technical data                                     | 74        |

# Pack contents

---



TaHoma® box



**Accessories for greater security**  
For example:



Indoor motion detector



Opening detector



Indoor alarm buzzer



Remote control

# Overview of the box



# Accessing TaHoma® *serenity*

## Installation:

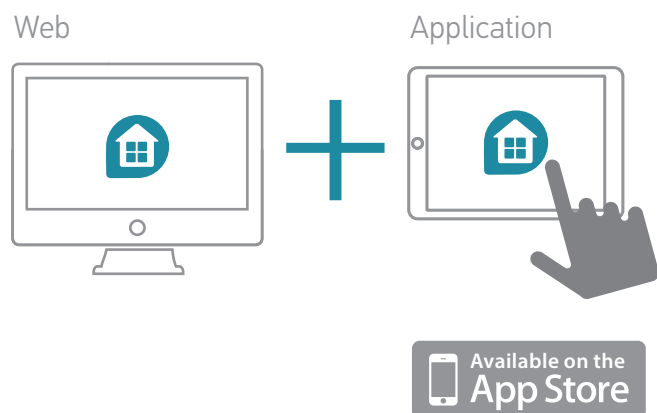

## Use:





# Warnings

Somfy cannot be held liable for any harmful consequences that might arise if the user has not followed the instructions given in the product guide, safety instructions and warnings below, or the **Precautions for Use available from the TaHoma® web interface and applications.**

## General

### As this is a wireless, connected solution

- You must have an Internet router with a high-speed connection in the home, to which the TaHoma® box can be connected.
- To fully enjoy all of the features of your product, do not disconnect the TaHoma® box or the home's Internet router (particularly during long absences such as weekends and holidays).
- Similarly, you must have access to an Internet connection to use the web interface or the mobile applications, at home or remotely.
- Optimum operation depends heavily on the installation and configuration of the products. Somfy recommends that the products be installed in accordance with the relevant instructions and guides.
- The presence of certain factors on the installation premises can reduce the expected benefits, such as:
  - The presence of metal objects or other objects that interfere with the radio signal
  - Depending on the conditions of use, the size and configuration of the building
  - Various factors linked to the combination of several technologies can affect the operation of these solutions, such as interruptions and variations in electronic networks or communication networks (Internet, GSM telecommunications network, etc.). These solutions require a power supply and appropriate telecommunications equipment.

This connected system requires that users and occupants take certain precautions:

- During configuration and use, users must take into account the surroundings of the home and each specific device, or any specific situation relating to each of the occupants.
- It must be checked periodically by the users for satisfactory operation, effectiveness and the suitability of the technologies used in relation to the expected level of protection.
- The Somfy Customer Service Department can provide advice and put you in contact with qualified security professionals if necessary.

## Security offered

- Somfy connected security solutions can only be used as means of preventing intruders and burglaries in conjunction with other solutions.
- Somfy connected security systems are not able to provide complete protection of the building and its occupants and have certain limitations. Somfy recommends that its connected security solutions be used to supplement other devices and that the appropriateness of other possible security devices be evaluated (e.g.: reinforcing the locks on doors or armoured doors, use of safety glazing, etc.).
- Malicious acts by individuals can reduce the efficiency of connected security devices. It may transpire that, in light of current criminal techniques, the technologies used do not or cease to provide the benefits expected by users, and a change of product may be appropriate.

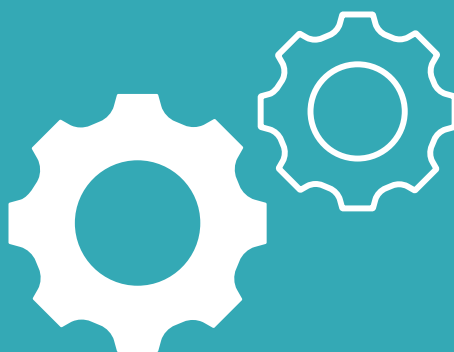

# Installation

# Installation steps

## 1. Connect the box



## 2. Create your account

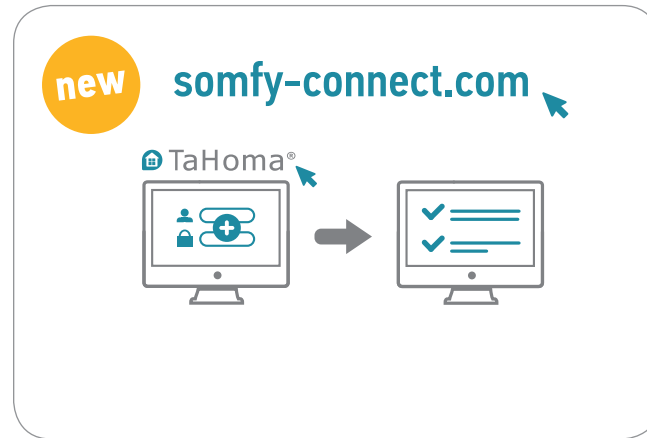

## 3. Configure the box & accessories

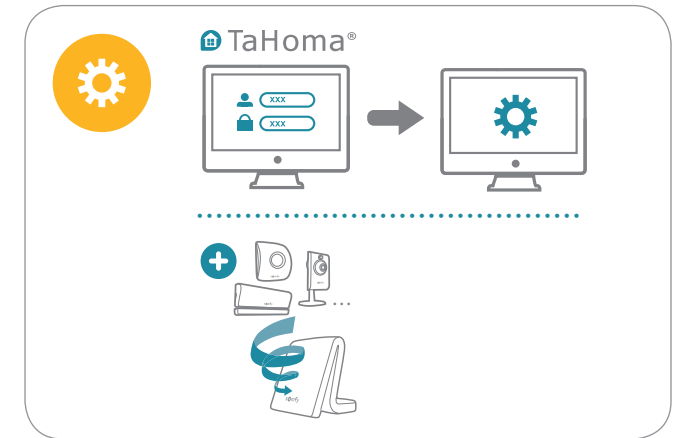

# 1. Connect the box

For packs including a Security base: 

Connect it to the TaHoma® box before connecting the box. Clip the TaHoma® box into place on the Security base. Follow the diagram shown on the top of the Security Base, and reproduced here →



1.

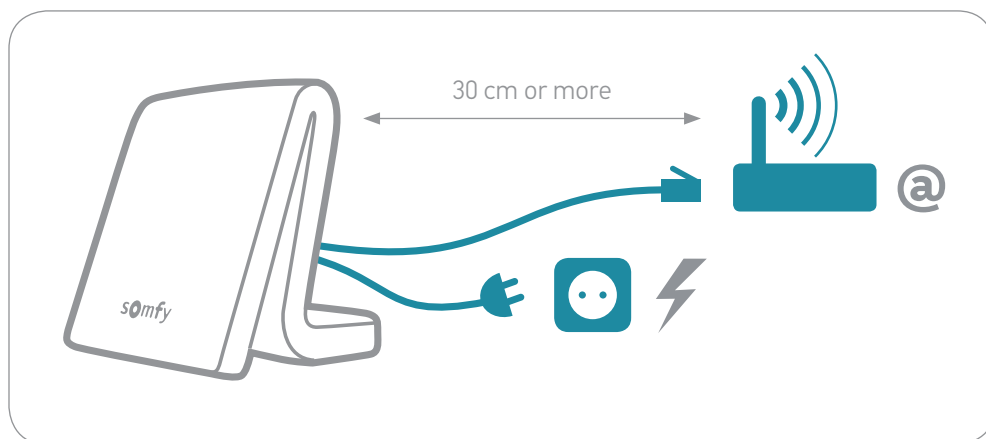

2.

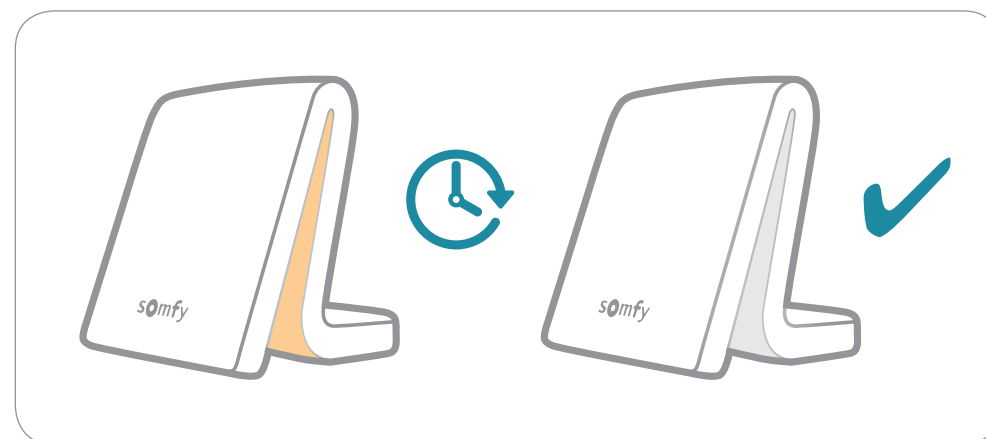

To improve the radio range, we recommend that the TaHoma® box be placed in an unconfined place in the middle of the house (avoid metallic surfaces and enclosures).



Do not disconnect the TaHoma® box during the initialisation sequence!

## 2. Create your account

1.

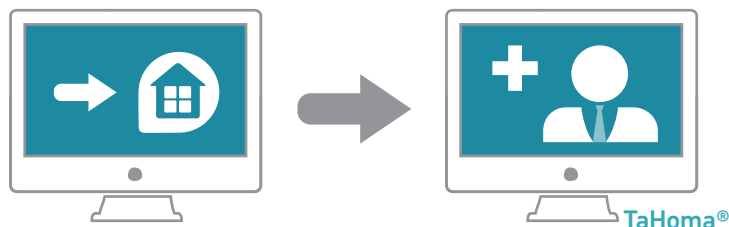

Go to [somfy-connect.com](https://www.somfy-connect.com)  
Then select **TaHoma®** and follow the instructions on the screen.

2.



**Confirm the account**  
via the email received.



You will then be able to download  
this guide.

You can now configure  
**TaHoma®** *serenity!*



# Connect me

... YOU WILL SOON BE ABLE TO ENJOY  
YOUR CONNECTED HOME!



# Your simple, adaptable connected home



**Your connected home - it couldn't be easier!**

Connect and control your devices at home or remotely.



**More comfort, security and energy efficiency**

Easy-to-create customised programmes.



**Adaptable**

Add new accessories and devices to your connected home at your own pace.

**Compatible with a wide range of devices from Somfy and its partners.**

See the list at [somfy.com](http://somfy.com)

# Easy to use



Somfy assists you in installing and using TaHoma®.

## Our video tutorials give you step-by-step guidance!

They are identified throughout the guide by this icon:



## [ Interactive guide ]

You can **click on the tutorial icon to open the video directly.**



List of video tutorials:

### GENERAL

 **Tutorial #1** Adding devices to TaHoma®

### MY HOME

 **Tutorial #2** Creating your home in TaHoma®

 **Tutorial #3** Creating your programmes: Scenarios

 **Tutorial #4** Creating your programmes: Smart

### + MY SECURITY

 **Tutorial #5** Configuring the connected alarm

 **Tutorial #6** Controlling the connected alarm + Alerts

## Need help?

Find support and a user forum on [somfy.com](https://www.somfy.com)



# 3. Configure your connected home

In just a few minutes, you will be able to enjoy all the benefits of your TaHoma® connected home.

1.

 TaHoma®



**Connect**  
to the TaHoma® web interface

2.

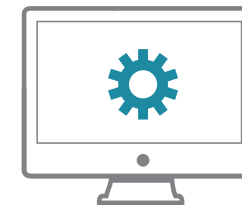

**Then follow**  
the instructions on the screen

Step 1: Add devices

Step 2: Customise your home

# 3. Configure your connected home

---





# 3.1 Add devices (1/2)

TaHoma® is compatible with a wide range of devices from Somfy and its partners.

These devices use different technologies, and are therefore grouped by family. The Somfy device families appear in the tabs by default.



**A USB extension is required to ensure compatibility with certain partners.**  
When it is connected, the corresponding family automatically appears in the tabs.

Follow the instructions on the screen to go to the **Configuration** section of the main menu:



then...

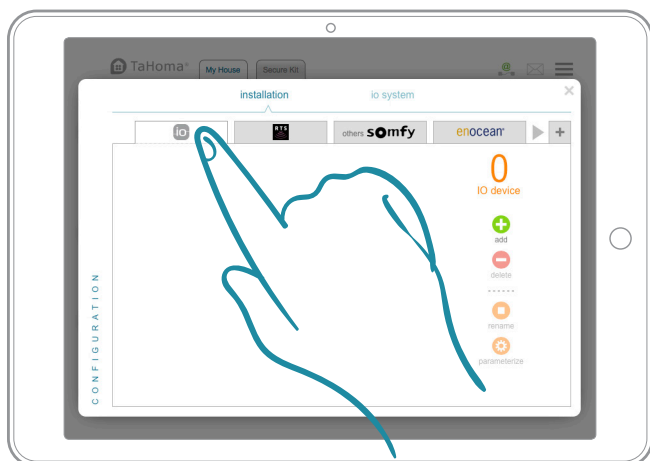

1. Select the technology used by the device that you want to add.



To find out which technology your Somfy device uses, look on the back of the product or the remote control for it.

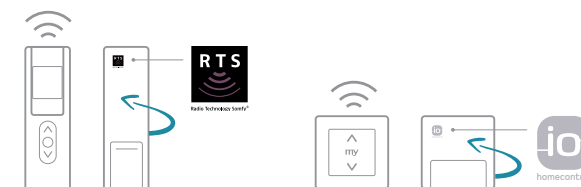

A full list of Somfy partners is available at [somfy.com](http://somfy.com)



## 3.1 Add devices (2/2)

2. Then click "add" and follow the instructions on the screen.

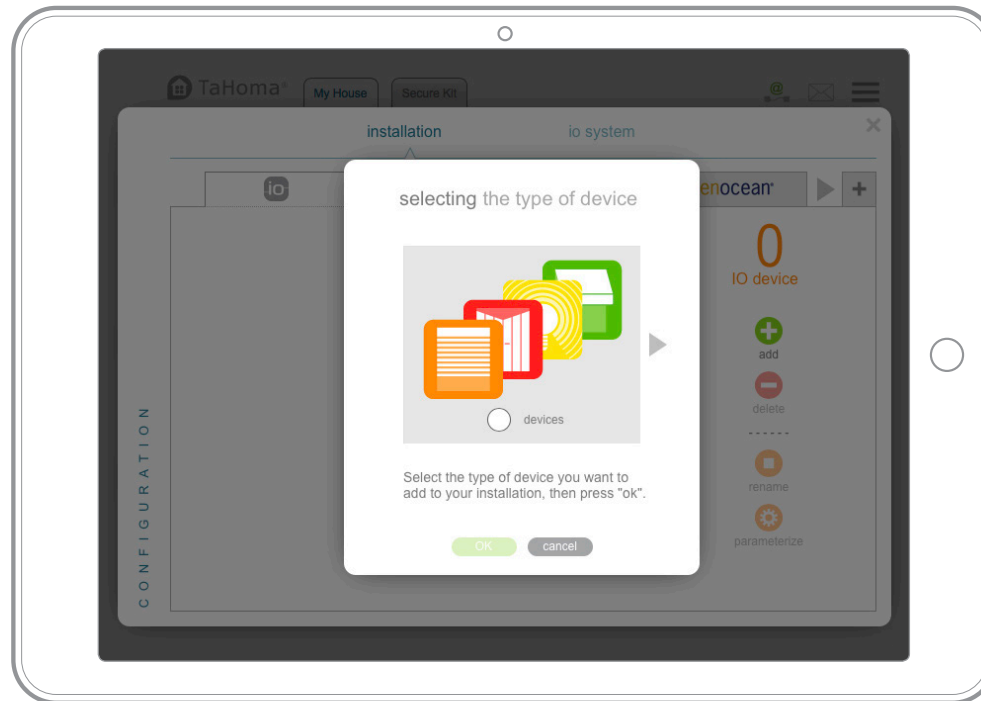

3. The icons for your devices appear in the central box.

A little bonus:

All of the  products in your home are added automatically in step (4).

You can go back to your settings at any time to add, modify or delete devices. From the main menu, access Configuration again.



If you rename your devices straight away, it will be much easier to find them again later.



If you have several similar devices, TaHoma® will also automatically create a "group" icon containing all of those devices.





# 3.2 Customise your home

For greater customisation, you will now recreate your home and the number of floors and/or rooms so that you can assign your devices to them.

Follow the instructions on the screen to go to the **Create home** section of the main menu:



Then follow the steps:

EXAMPLES

1

### Type of residence

Select your type of residence



2

### Environments

Customise the environment of your home if you wish



3

### Interior decoration

Add interior decoration if you wish



4

### Rooms

Select ALL of your floors and distribute the rooms if you wish

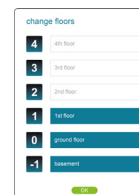

5

### Devices

Distribute your devices

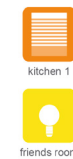
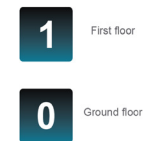

You will then be able to see your connected home, with:

- an overall view of the devices (by default)
- or a listing by room

# Then download the TaHoma® application

For even simpler everyday use, in addition to the web interface, install **the TaHoma® application** for smartphone & tablet!

The diagram illustrates the TaHoma application interface. On the left, a tablet displays the web interface with a sidebar menu (SCENARIOS, AGENDA, SMART) and a main area showing a house outline with various device icons like roller shutters, camera, indoor siren, light, thermostat, security base, TaHoma box, temperature sensor, motion sensor, opening sensor, and scenario player. A smartphone next to it shows the mobile app interface with similar icons. To the right, there are QR codes for downloading the app from the App Store and Google Play, with icons for an Apple Watch, iPhone, iPad, and another smartphone/tablet below them.

# Congratulations!

---

Your home is now connected.

The following pages will help you get started.



# Configure the box and accessories

In just a few minutes, you will be able to enjoy all the benefits of your TaHoma® *serenity* connected alarm.

1.

TaHoma®



**Connect**

to the TaHoma® web interface

2.



**Then follow**

the instructions on the screen

Step 1: Add the pack security accessories

Step 2: Configure security



my security



## 3.1 Add the pack security accessories (1/3)

To install the accessories, please refer to the **relevant guides**.

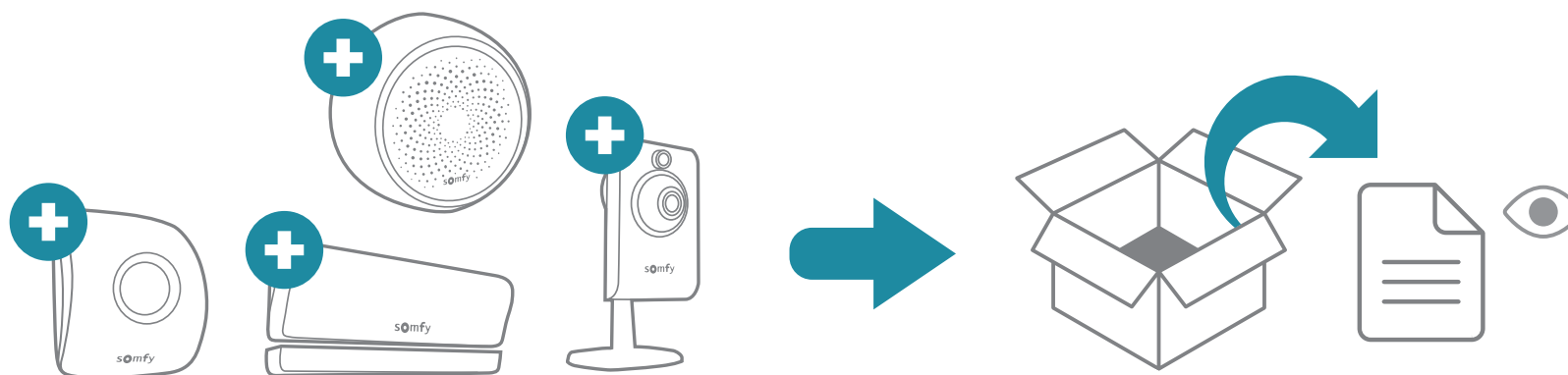

# 3.1 Add the pack security accessories (2/3)

TaHoma® is compatible with a wide range of devices from Somfy and its partners.

These devices use different technologies, and are therefore grouped by family. The Somfy device families appear in the tabs by default.

Follow the instructions on the screen to go to the **Configuration** section of the main menu:

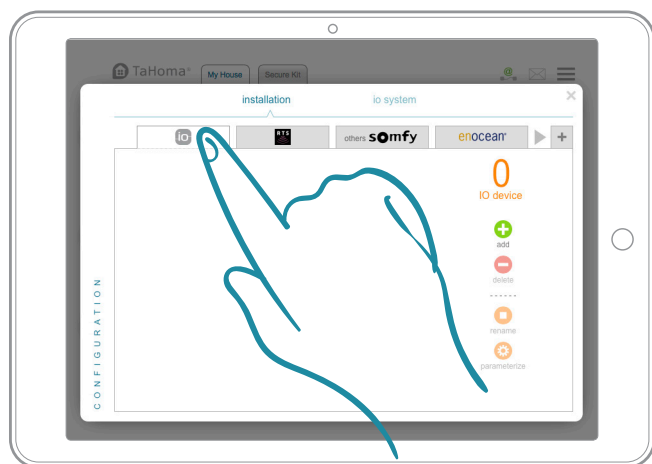
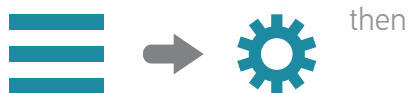

1. Select the technology used by the device that you want to add.



To find out which technology your Somfy device uses, refer to the relevant guide or look on the back of the product or the remote control for it.



 A full list of Somfy partners is available at [somfy.com](http://somfy.com)

## 3.1 Add the pack security accessories (3/3)

2. Then click "add" and follow the instructions on the screen.

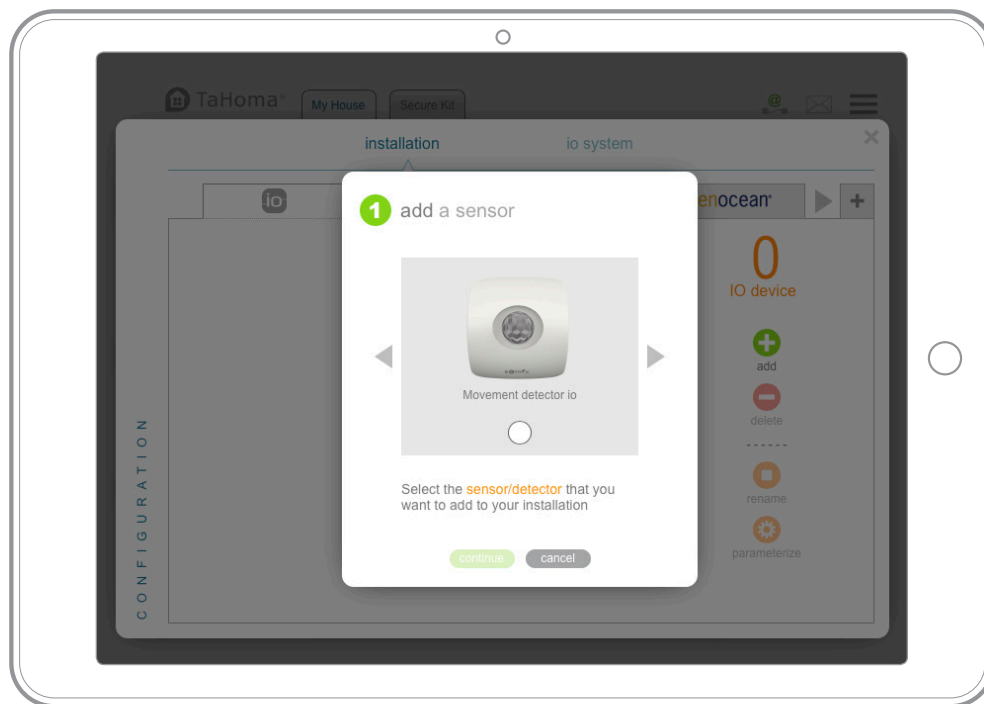

3. The icons for your devices appear in the central box.

You can go back to your settings at any time to add, modify or delete devices. From the main menu, access Configuration again.



If you rename your devices straight away, it will be much easier to find them again later.



If you have several similar devices, TaHoma® will also automatically create a "group" icon containing all of those devices.



# 3.2 Configure security (1/6)



## > Explanation

### SECURITY MODES

The TaHoma® connected alarm solution includes **four safety modes** for your home:

- Total protection (ON)
- Two partial protection settings (ON - customised)
- Protection deactivated (OFF)



#### TOTAL

ON, all the sensors are active

##### In the event of an intrusion:

- The alarm buzzer sounds.
- You are sent alerts (notifications, emails, SMS).
- Your other security accessories are activated.
- You can also enjoy the benefits of enhanced security with automatic activation of home devices (lighting, shutters, etc.).



#### PARTIAL 1 AND PARTIAL 2

ON, customised

##### Protection suited to your needs.

These two modes offer the same functionality as the Total mode. However, you can choose the sensors and can deactivate the alarm buzzer (silent alarm).



#### DEACTIVATED

OFF

##### All the sensors are deactivated.



For a more comfortable return home, your connected devices can be activated. For example: the light comes on and the shutters open.

Configure these modes for tailored security (details on p. 22).

## 3.2 Configure security (2/6)



### > SOS Function

You can also use the SOS function to react and alert your friends and relatives in an emergency.

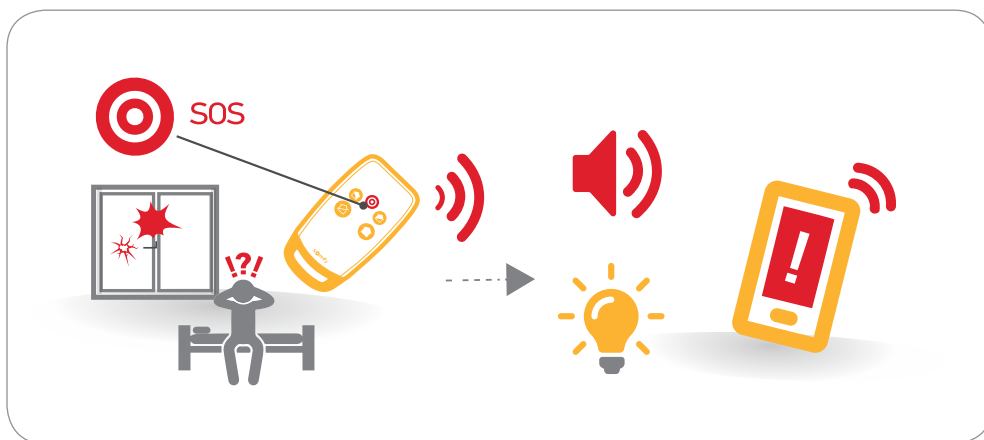

Configure this function in the same way (details on p. 23).









### > Other settings

Configure additional security settings (details on p. 24).

# 3.2 Configure security (3/6)



## > Summary

|  | <br><b>TOTAL</b> | <br><b>PARTIAL 1</b> | <br><b>PARTIAL 2</b> | <br><b>DEACTIVATED</b> | <br><b>SOS</b> |
|--|---|---|---|---|---|
| <b>Detectors</b><br>  | All activated   | Selected items activated  | Selected items activated  | -   | -   |
| <b>Alerts</b><br><br>Optional SMS<br>(depending on availability) | In the event of an intrusion  | In the event of an intrusion  | In the event of an intrusion  | When the system is deactivated  | When the button is pressed  |
| <b>Activated devices</b><br>                                    | In the event of an intrusion  | In the event of an intrusion  | In the event of an intrusion  | When the system is deactivated  | When the button is pressed  |

# 3.2 Configure security (4/6)



## > Configure security modes

Follow the instructions on the screen to go to the **Edit** section of the Security bar:

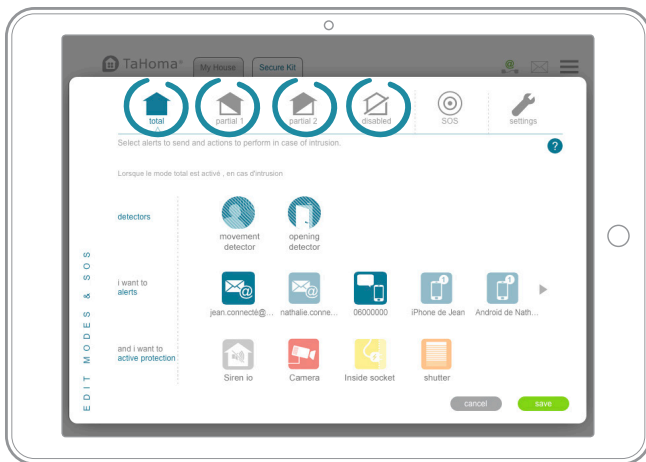

### Configure the desired security modes in three steps:

1. Select the detectors to be activated (only for the two partial modes. All of the detectors are activated in Total mode).
2. Select the alerts to be sent in the event of an intrusion.
3. Select the devices to be activated in the event of an intrusion or if the system is deactivated (alarm buzzer, camera, electrical outlet, etc.).



## 3.2 Configure security (5/6)



### > Configure the SOS function

Configure the security modes in the same way, in just two steps:

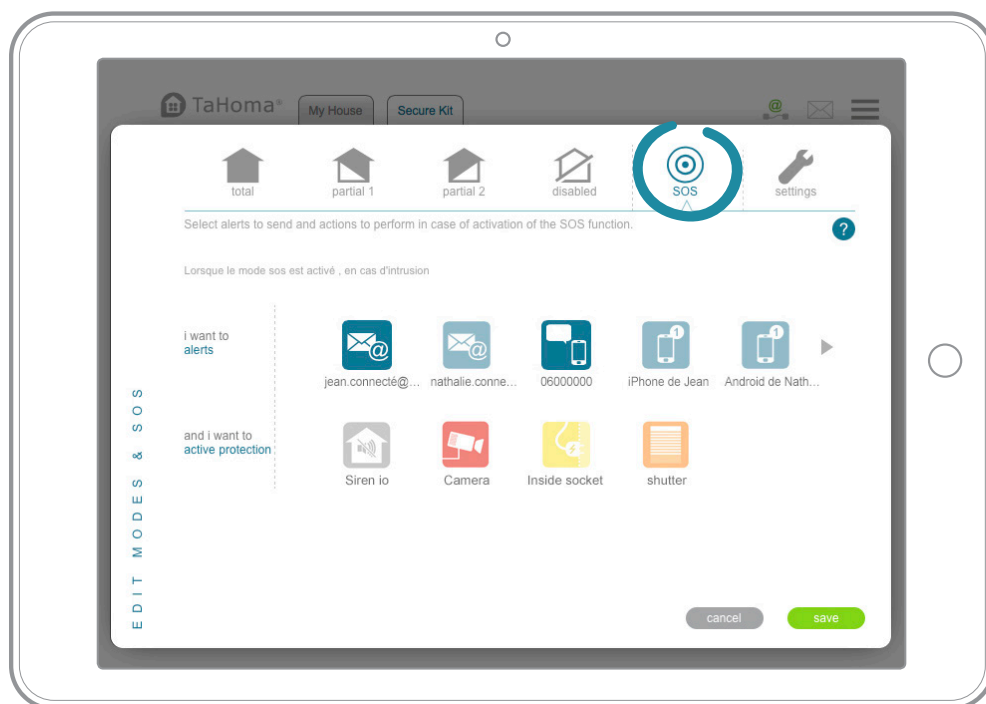

1. Select the alerts to be sent.

2. Select your devices and the actions to be performed.

# 3.2 Configure security (6/6)



## > Other settings

Two additional types of setting are available:

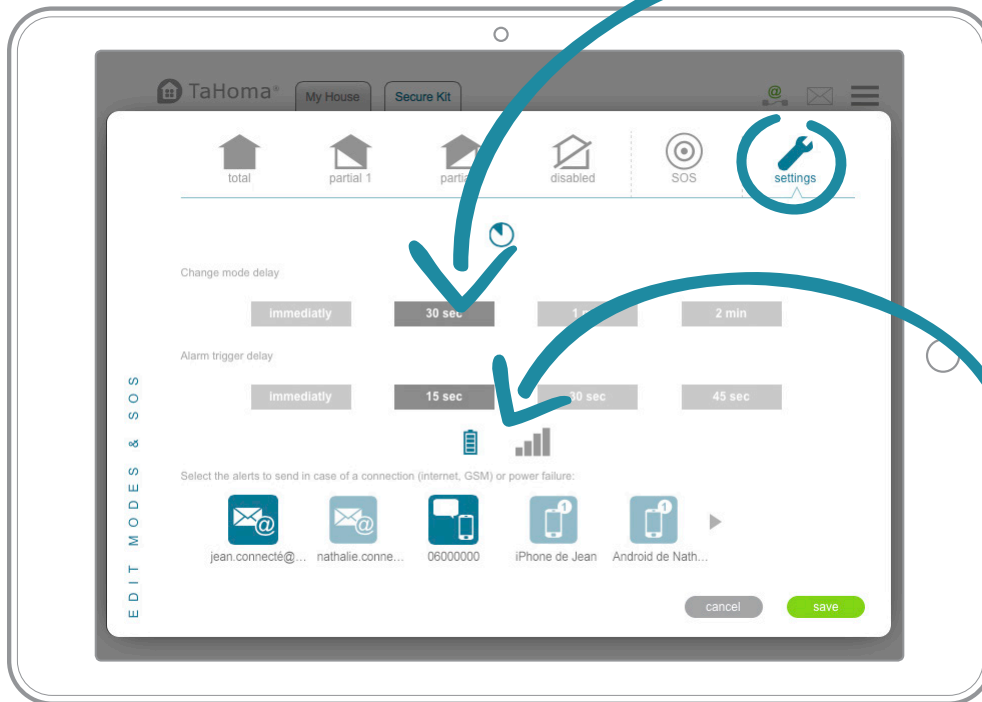

**Times** - security system setting time  
- activation time in the event of an intrusion



**Only visible if the security base (available separately) has been added to TaHoma®**

Selection of the alerts relating to temporary backup functions:

- If the event of
  - a power cut at home
  - Internet failure
- And on return to normal



You can come back to your settings at any time to modify or delete them.  
In the my security screen, click the icon for the relevant mode and proceed as shown previously.

# Then download the TaHoma® application

For even simpler everyday use, in addition to the web interface, install **the TaHoma® application** for smartphone & tablet!

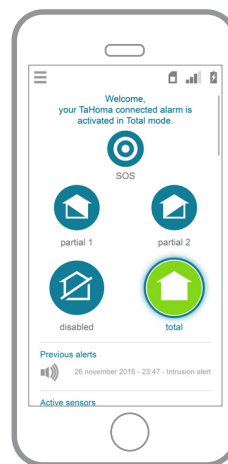
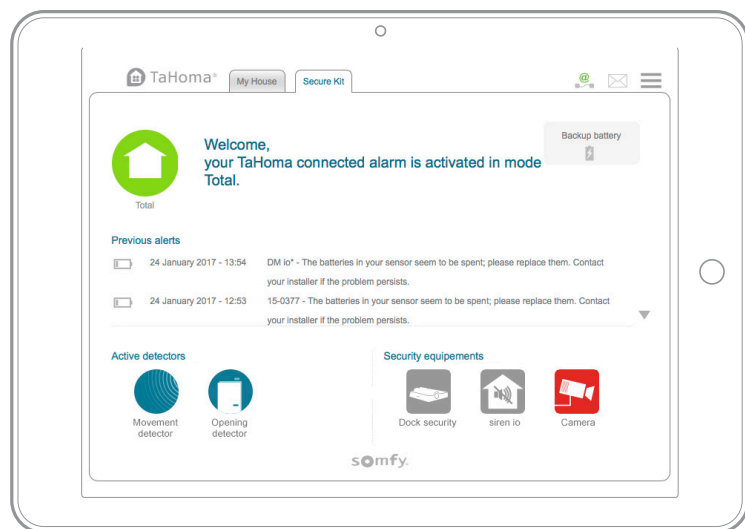

# Congratulations!

---

Your home is now secured & connected.

The following pages will help you get started.





Use



# Overview of the interface (1/4)

## Web + iPad application

### Overall view:

- 1** Your home's security system  
*Details on next page*
- 2** Main menu
- 3** Notification bar

The screenshot shows the TaHoma iPad application interface. At the top, there is a header with the TaHoma logo, 'My House', and 'Secure Home'. Below the header, a green house icon is followed by the text 'Welcome, your TaHoma connected alarm is activated in mode Total.' A notification bubble for 'Backup battery' is visible. Underneath, there is a 'Previous alerts' section with two entries from January 24, 2017, regarding battery issues. Below that is an 'Active detectors' section with icons for 'Movement detector' and 'Opening detector'. To the right is a 'Security equipments' section with icons for 'Dock security', 'siren.io', and 'Camera'. At the bottom right, there is a main menu with options: 'My account', 'Habitat creation', 'Configuration', and 'Logout'. At the very bottom, there is a notification bar with three items: 'Faults detected' (with a red triangle icon), 'TaHoma® connection status' (with an @ icon), and 'Messages' (with an envelope icon). Three blue callout lines with numbered circles (1, 2, 3) point to the main content area, the main menu, and the notification bar respectively.



# Overview of the interface (2/4)

## Web + iPad application

### Your home's security system:

- 1 Real-time security status of your home
- 2 Security settings and control
- 3 Most recent alerts
- 4 Detectors used in current security mode
- 5 All of the security devices connected to TaHoma®

The interface on the iPad is annotated with five numbered callouts:

- 1** Points to the top navigation bar containing 'TaHoma', 'My Home', and 'Secure Kit'.
- 2** Points to the 'Total' status indicator (a green house icon).
- 3** Points to the 'Previous alerts' section, which lists two alerts from January 24, 2017, regarding battery levels in sensors.
- 4** Points to the 'Active detectors' section, showing 'Movement detector' and 'Opening detector'.
- 5** Points to the 'Security equipments' section, showing 'Dock security', 'siren io', and 'Camera'. A red icon next to it is labeled 'Access the device window:'. An inset window shows a 'SOMFY VIDEO' feed of a living room with a 'REC' indicator and a 'Close' button.



# Overview of the interface (3/4)

## Smartphone application

### Overall view:

- 1** Your home's security system  
*Details on next page*
- 2** Main menu







# Overview of the interface (4/4)

## Smartphone application

### Your home's security system:

- 1 Real-time security status of your home
- 2 Control security
- 3 Most recent alerts
- 4 Detectors used in current security mode
- 5 All of the security devices connected to TaHoma®

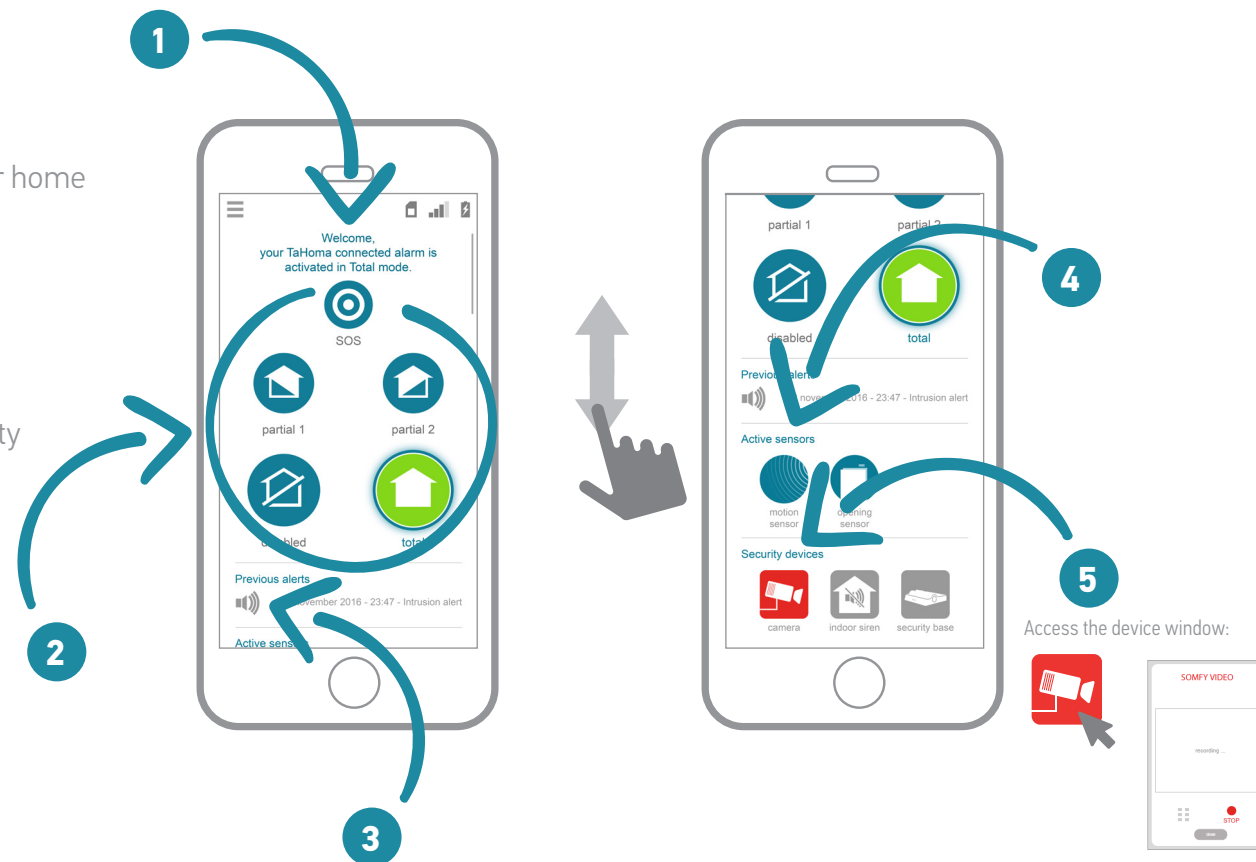

# Use cases

## 1. Control security

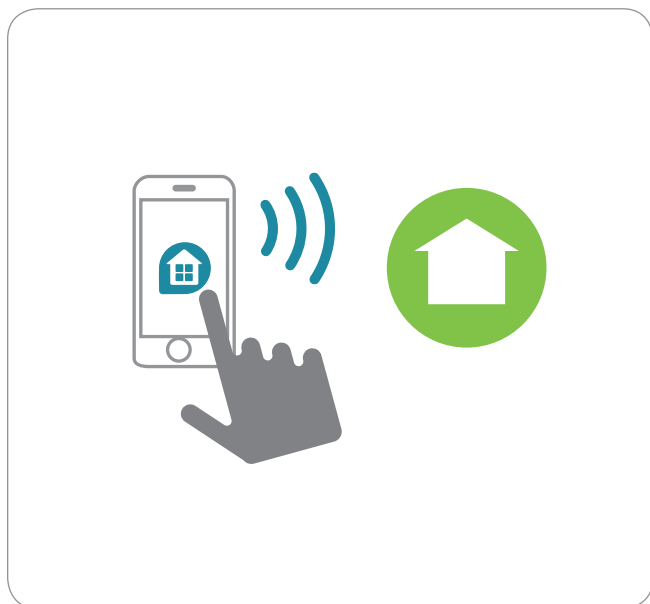

## 2. Alerts in the event of an intrusion or SOS

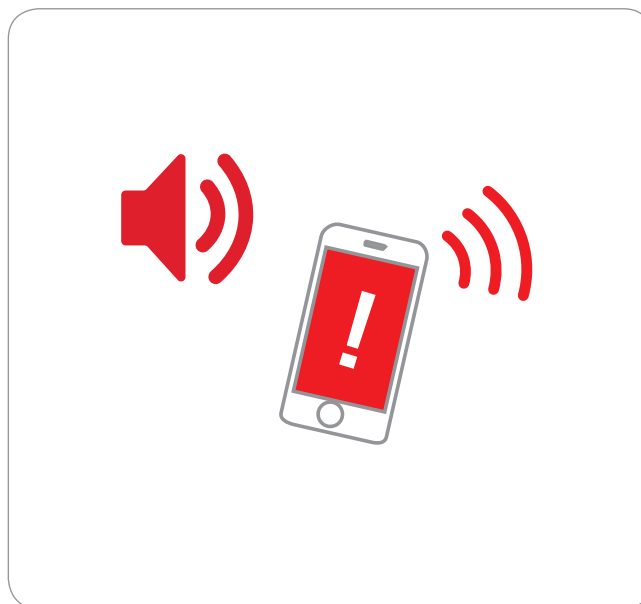

## 3. A few extras





# 1. Control security (1/3)

## 1.1 Activate a security mode

From your computer, tablet

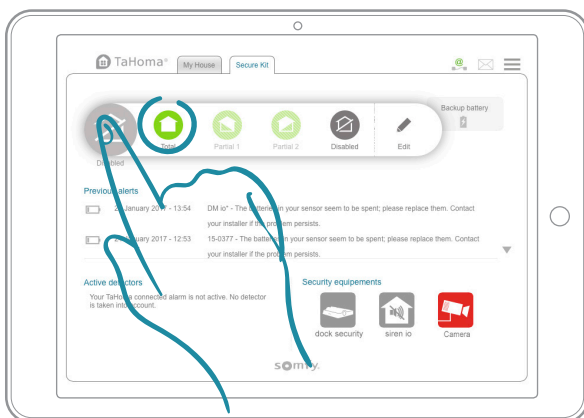

or smartphone

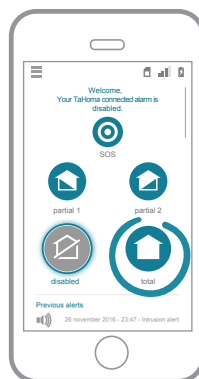

Click on the required mode to activate it.

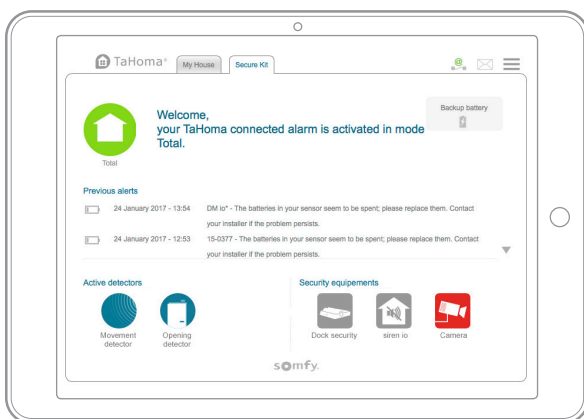

The selected mode is displayed in green.

The associated sensors are displayed at the bottom of the screen.

**Your home is now secured!**

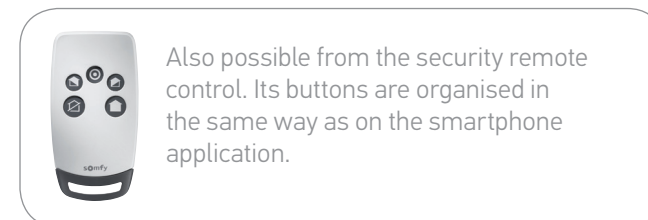



# 1. Control security (2/3)

## 1.2 Real-time security status information

From your computer, tablet

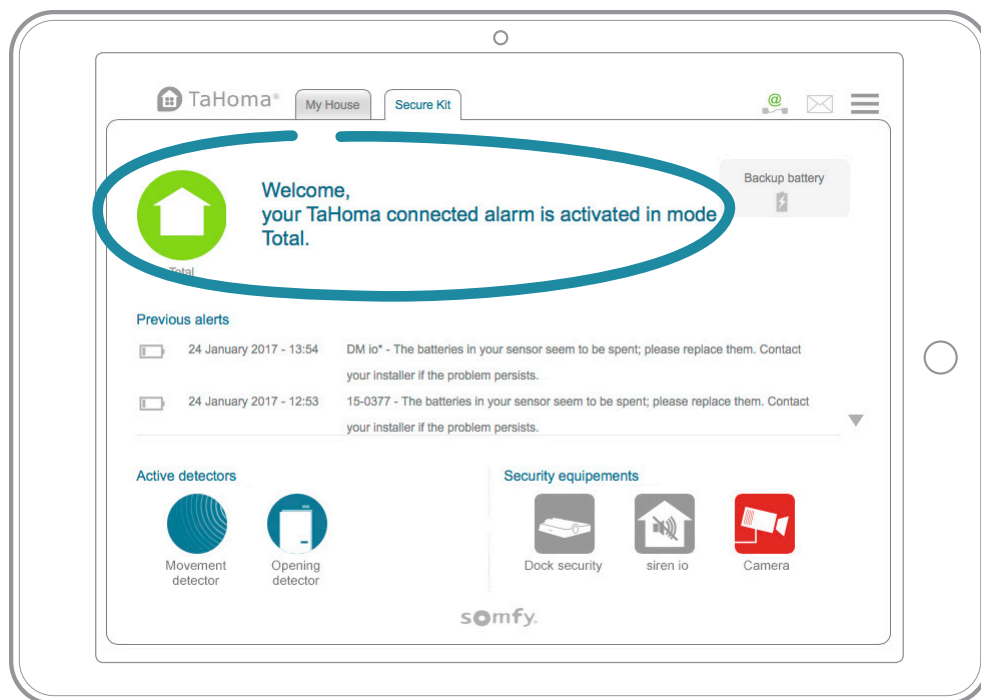

or smartphone



For even more peace of mind, you can make sure that everything's fine at a glance.



# 1. Control security (3/3)

## 1.3 Deactivate security

From your computer, tablet



or smartphone



Once you get back home, **just click once to deactivate the system.**



**And your home will welcome you just as you have specified.**

For example, the shutters will be opened when the system is deactivated.



Also possible from the security remote control. Its buttons are organised in the same way as on the smartphone application.

## 2. Alerts in the event of an intrusion or SOS (1/4)

### 2.1 Overall view in the event of an intrusion

If your protection is activated, TaHoma® alerts you if an intrusion is detected.

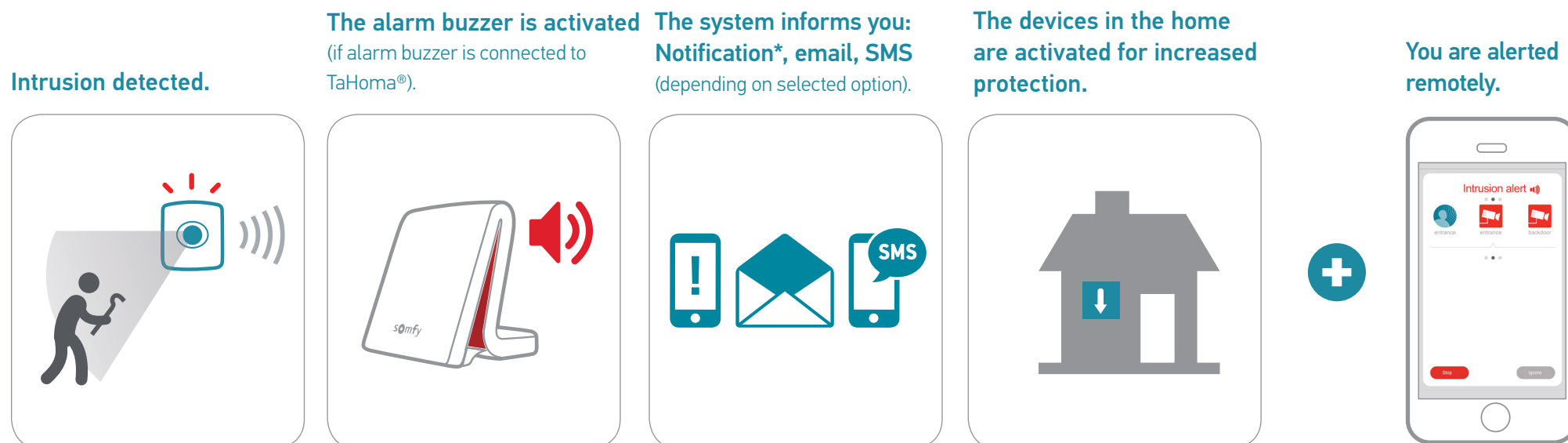

\* If you want to receive notifications, you must first activate them in the TaHoma® application (accept them when you open the application for the first time or otherwise go to the settings in your smartphone/tablet).

## 2. Alerts in the event of an intrusion or SOS (2/4)

### 2.2 Alert screen

If your protection is activated, TaHoma® alerts you if an intrusion is detected.

End the alert. TaHoma® then switches to deactivated mode.

Exit the screen but the alert continues (for example, the alarm buzzer continues to sound).

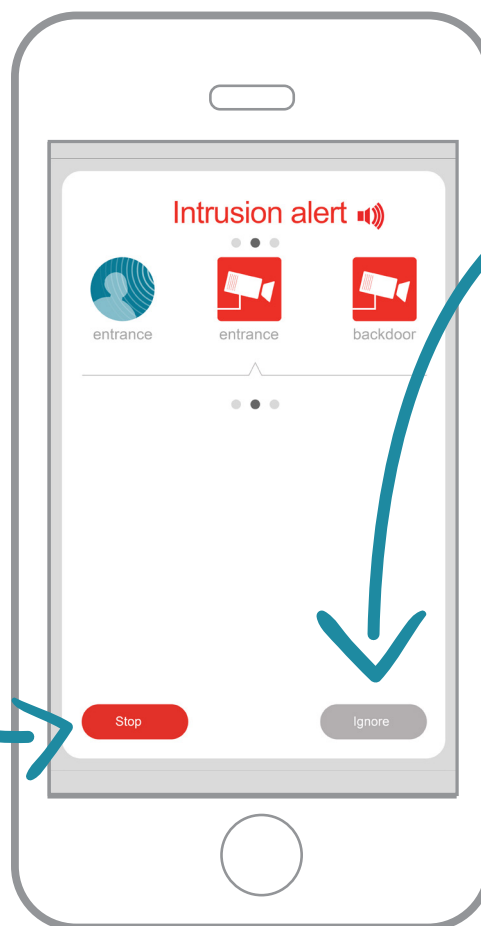

**On a computer or tablet:**

the alert screen is similar to this, except that the telephone pad button is not displayed.

## 2. Alerts in the event of an intrusion or SOS (3/4)

### 2.3 Video alert screen (if a camera has been added to TaHoma® & is in a security mode)

If you have a Somfy Visidom camera and it is configured in an active security mode: **it automatically records a video lasting one minute from the start of the alert.**

To access it, click the corresponding icon.

- During recording, the live image is displayed to give you greater reassurance.
- If you log in after recording has terminated, you can watch the video directly.
- You can see all of the videos recorded by going to the My security screen and clicking the camera icon.

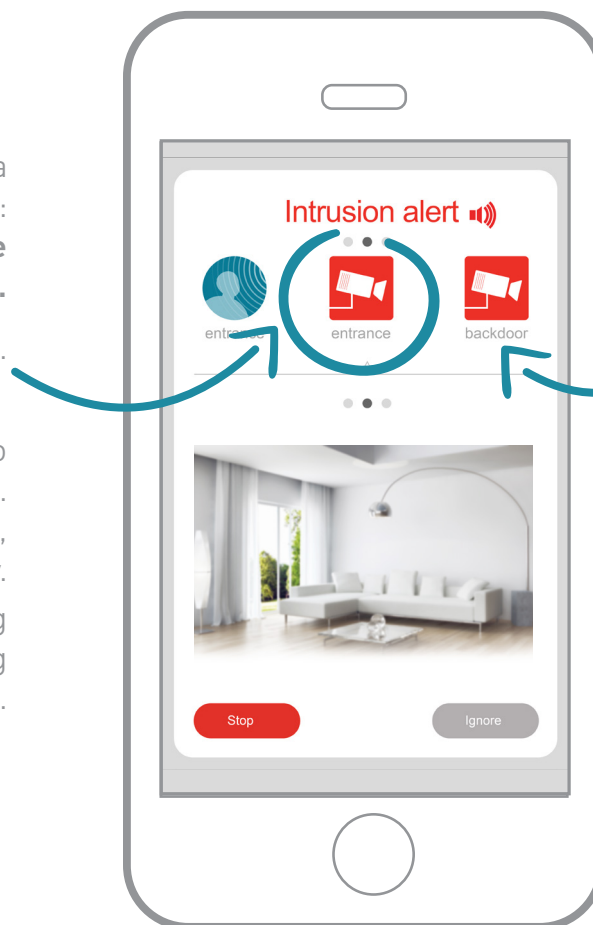

Your other cameras are also available for direct viewing.



## 2. Alerts in the event of an intrusion or SOS (3/4)

### 2.4 In the event of an SOS

In an emergency, alert a friend or relative with a single click and react thanks to the SOS function (irrespective of whether or not a security mode is active).  
From your smartphone or the security remote control:

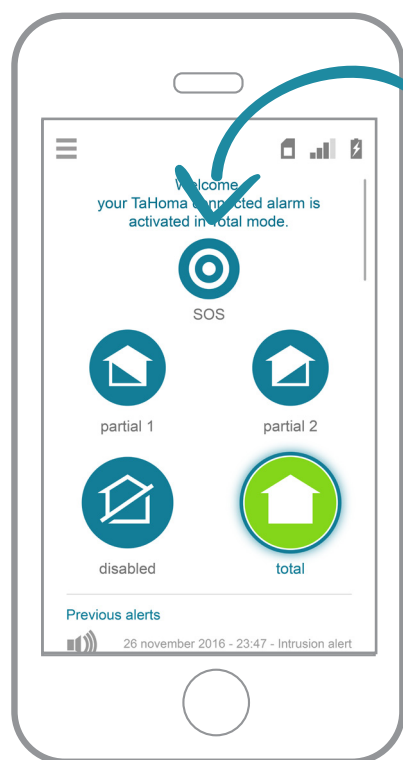

Click the SOS button.



Press for two seconds.

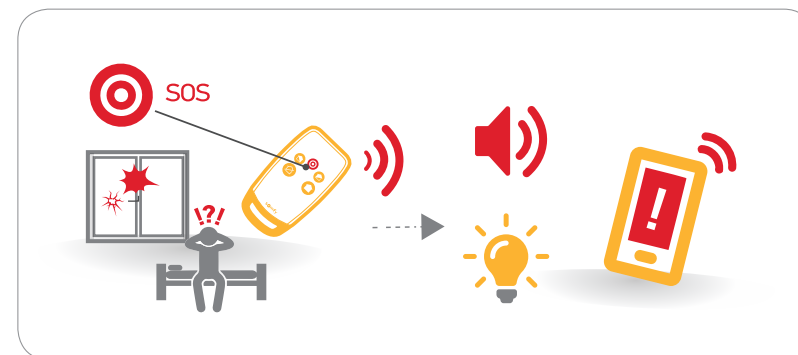

To stop an SOS alert, switch to Deactivated mode  .



# Enhanced Connection

with TaHoma®



# Your alarm is also a connected home solution (1/2)

Enjoy the benefits of a connected home solution directly incorporated into your alarm.



**Connect and control your devices remotely** using your smartphone.

Create **customised programmes** for more comfort, security and energy efficiency.

## Reassuring

Access the **my home** interface and dedicated functions.

## And adaptable

Add new devices and accessories to your system at your own pace.

A whole range of compatible products:

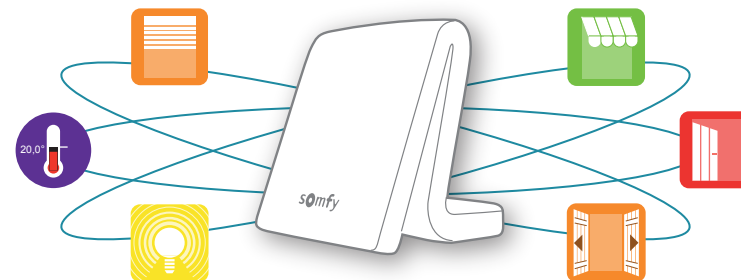

# Your alarm is also a connected home solution (2/2)

To access my home:

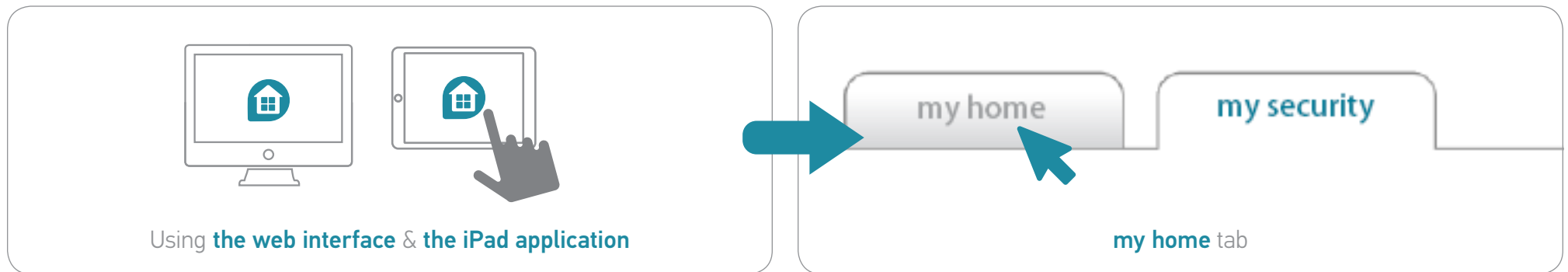

Click the **my home** button to start!

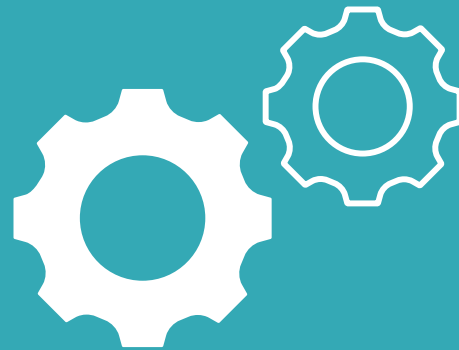

# Installation

# 1. Installation steps

---

## Step 1: Add your devices



## Step 2: Configure your home





# 1. Add devices

Follow the same procedure as on start-up to add new devices:

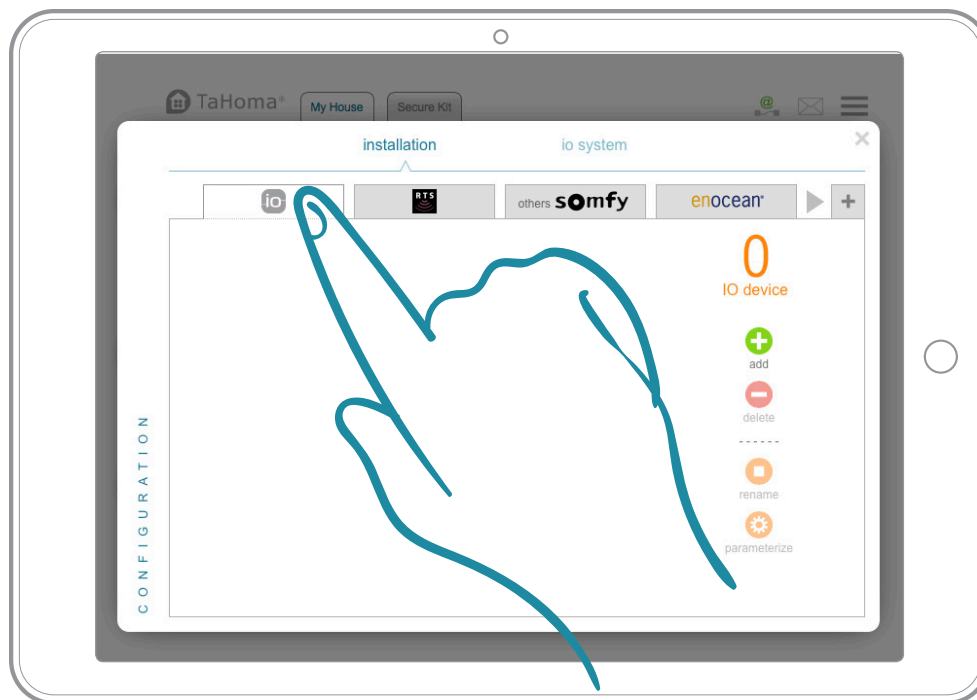

1. Select the technology used by the device that you want to add.

See p. 17 for full instructions.



# 2. Configure your home

For greater customisation, you will now recreate your home and the number of floors and/or rooms so that you can assign your devices to them.

Follow the instructions on the screen to go to the **Create home** section of the main menu:



Then follow the steps:

EXAMPLES

1

### Type of residence

Select your type of residence



2

### Environments

Customise the environment of your home if you wish



3

### Interior decoration

Add interior decoration if you wish



4

### Rooms

Select ALL of your floors and distribute the rooms if you wish

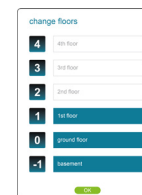

5

### Devices

Distribute your devices

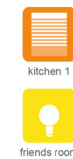
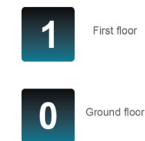

You will then be able to see your connected home, with:  
 - an overall view of the devices (by default)  
 - or a listing by room





Use



# Overview of the interface

## Web + iPad application

- 1 Your home & your devices
- 2 Your customised programmes
- 3 Main menu
- 4 Notification bar





# Overview of the interface

## Smartphone application

- 1 Your home & your devices
- 2 Main menu
- 3 Your customised programmes

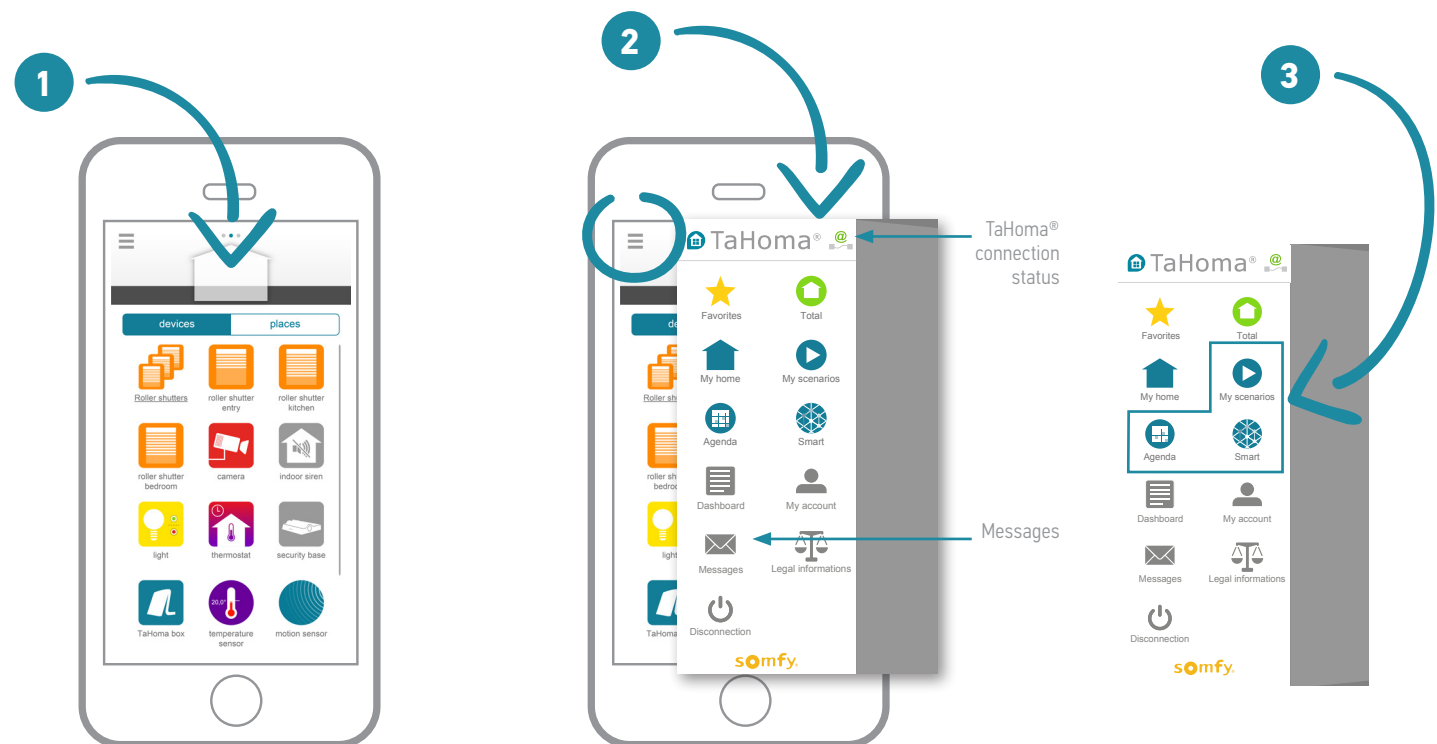

# Use cases

## 1. Control your devices

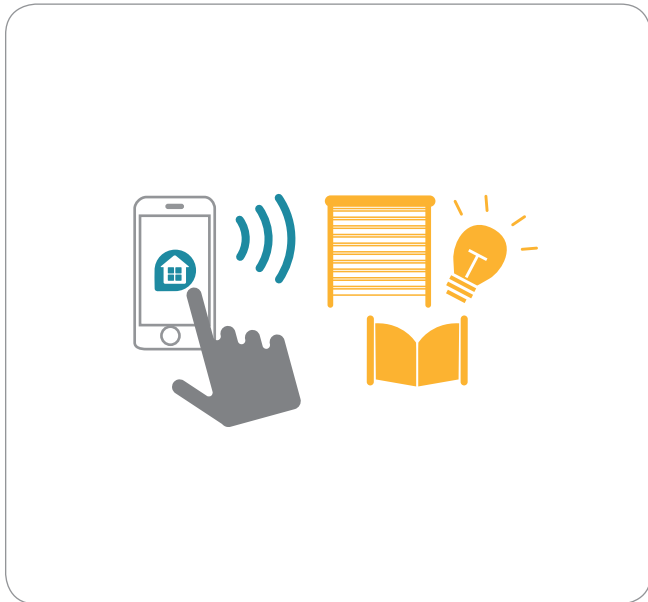

## 2. Create your customised programmes

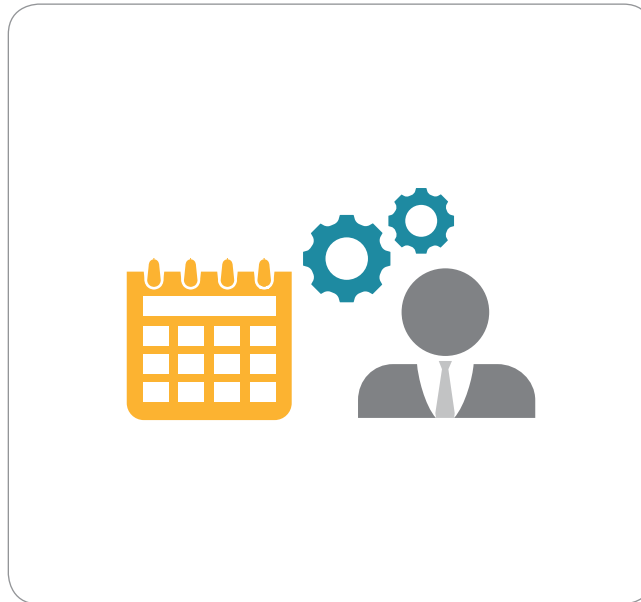

## 3. A few extras



# 1. Control your devices

With TaHoma®, it's easy to control your house...

## FROM HOME

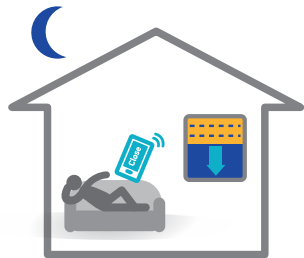

**In my living room  
in the evening:**

I use my tablet to close the shutters on my home from the comfort of the sofa.

OR

## REMOTELY

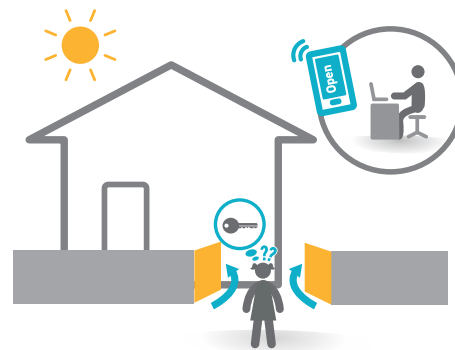

**During the working day:**

I use my smartphone to open the gate for my daughter when she forgets her keys. Handy!

Using **the web interface** or **the application**.



# 1.1 Example devices and icons (non-exhaustive list)



|  <p>OPENING SYSTEMS</p>     |  <p>ACCESS, ALARMS &amp; SECURITY</p> |  <p>OUTSIDE</p>     |  <p>LIGHTING</p> |  <p>ENERGY MANAGEMENT</p> |  <p>DETECTORS</p> |
|--|--|--|---|--|--|
|  Roller shutter             |  Swing gate                           |  Patio awning       |  ON/OFF light    |  Temperature sensor       |  Motion detector  |
|  Roller shutter on skylight |  Garage door                          |  Horizontal pergola |  Dimmer light    | etc.   |  Opening detector |
|  Exterior vertical blind    |  Sliding garage door                  |  Vertical pergola   |  ON/OFF socket   |  | etc.   |
|  Exterior Venetian blind    |  Alarm                                | etc.   | etc.  |  |  |
|  Skylight                  |  Sliding gate                        |  |   |  |  |
|  Roof awning              |  Camera                             |  |   |  |  |
|  Interior Venetian blind  | etc.   |  |   |  |  |
|  Shutter                  |  |  |   |  |  |
| etc.   |  |  |   |  |  |

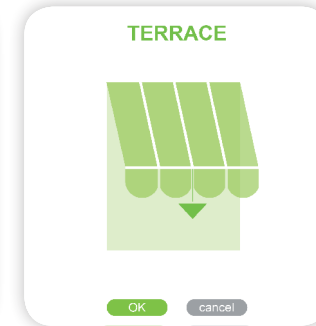
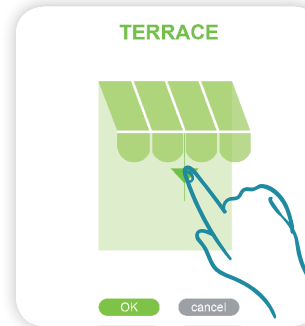
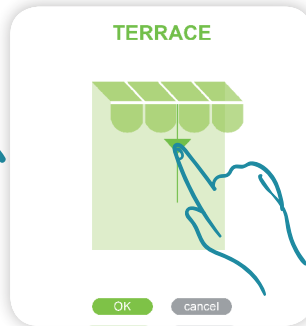

 **TaHoma® is adaptable:** compatible with a wide range of devices from Somfy and its partners (list of compatible devices at [somfy.com](http://somfy.com)).

# 1.2 Control your devices in real time



**Set the desired position and click OK.**

 A group is controlled in the same way as an individual device. 

 **Malfunction detected on a device.** 

# 1.3 Monitor your sensors

View the history for a sensor (temperature, sunlight, etc.).  
 The history can be viewed in four different time formats:  
 Daily/Weekly/Monthly/Yearly.



To view the history,  
**click on the  
 sensor.**

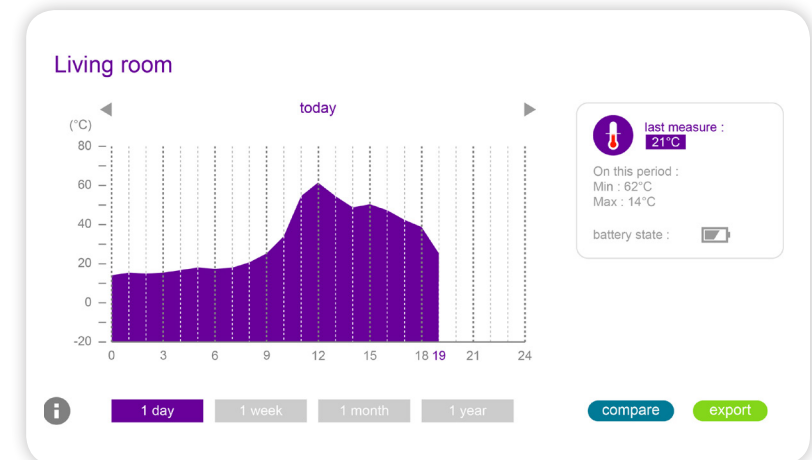



# 1.4 Store your favourite devices



Smartphone application only

TaHoma® makes it easy to find the devices that you use every day.

Select the device.

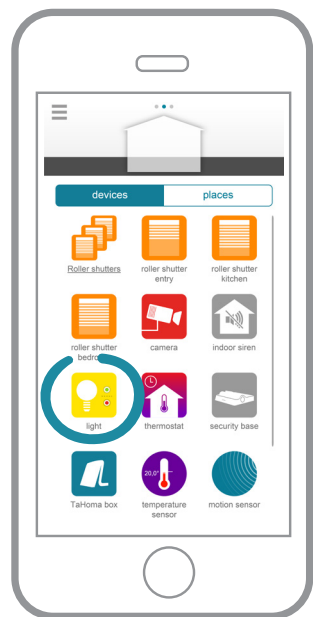

Click on the star.

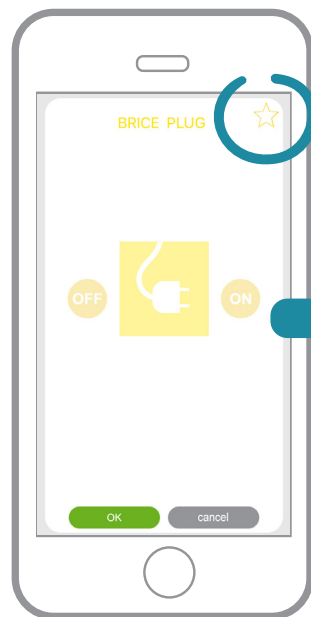

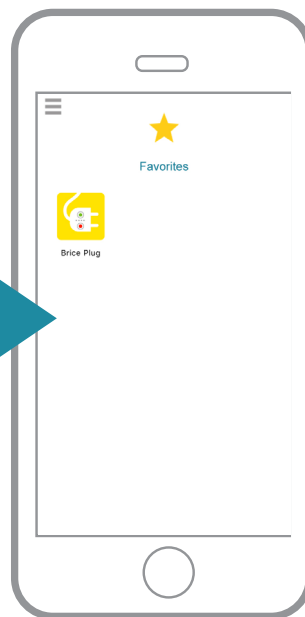

The device is now shown on the favourites list.

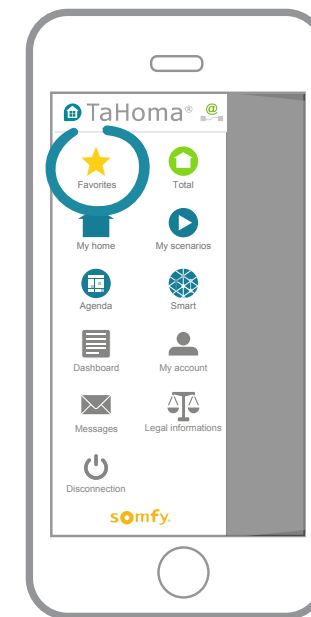

This page now opens by default on connection.

You can also find your favourites in the main menu.



 The favourites are specific to each smartphone (making them fully customised).

## 2. Create your customised programmes

 TaHoma® also brings you **more comfort, security and energy efficiency.**

Choose from three types of programme to customise your connected home:



Scenarios



Schedule



Smart

EXAMPLES

LEAVING IN THE MORNING



WEEKENDS AT 9 AM

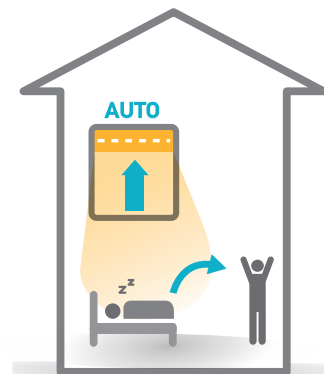

COOL HOUSE

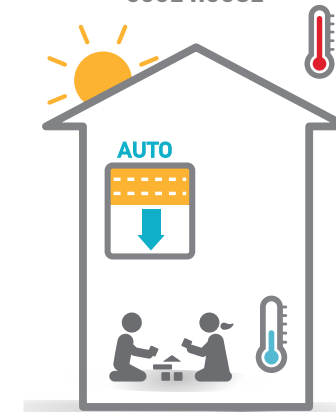



## 2.1 Scenarios (1/2)

### Your situations

Activate all of the devices to suit your needs or mood with just one click.

EXAMPLE

#### LEAVING IN THE MORNING



#### When I leave for work in the morning:

I start the scenario with just one click on my smartphone:

- the lights switch off,
- the heating switches to eco mode for the day,
- and the shutters close.

# ▶ 2.1 Scenarios (2/2)



## > Create a scenario



Drag the devices that you want to configure.

Click save and give the scenario a name.

## > Run a scenario

- They can be:
- Started immediately, or deferred for up to two hours.
  - Incorporated into the other programmes (Schedule and Smart).
  - Started using the touch-sensor button on the box (not available on old versions of the box).



Start it immediately by dragging it to:



Or defer it by dragging it to the time bar (scenarios can be deferred for up to two hours).

## > Store a scenario as a favourite on the smartphone application

Follow the same procedure as for a device: See p. 55 for more details.

## 2.2 Schedule (1/4)

### Your lifestyle

Set your home up to suit your **day-to-day** habits.

EXAMPLE

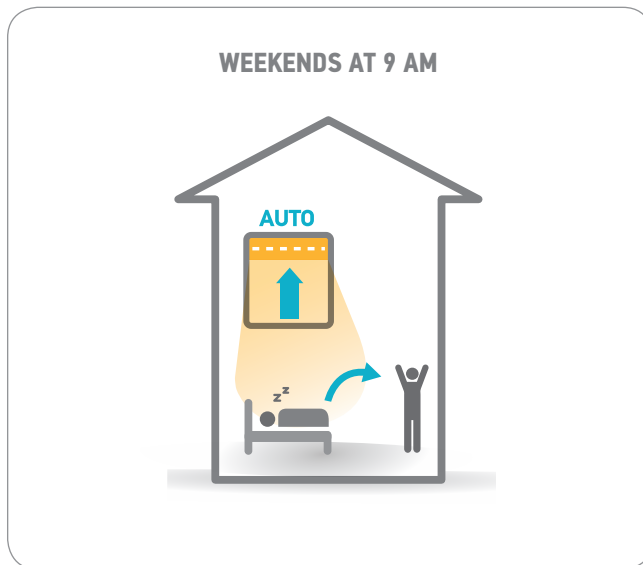

Weekends at 9 am:  
I'm gently woken by the light coming in  
**when the shutters open as scheduled.**

# 2.2 Schedule (2/4)

## > Explanation

Programme typical days and then distribute them in the schedule. Days can be programmed for a whole year.

You can create typical days:

- By adding devices
- By adding new or existing scenarios
- By associating scenarios with devices

For example:

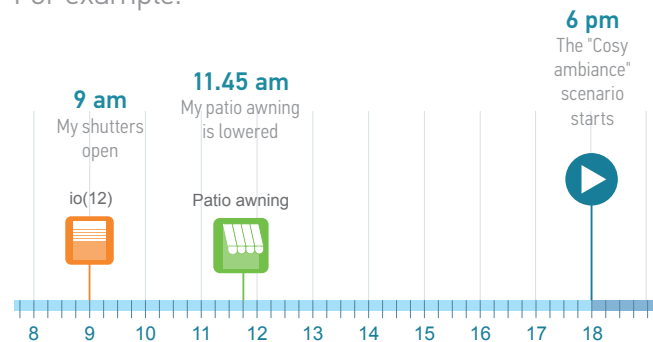

# 2.2 Schedule (3/4)

> Create a day

1. Create a new day.

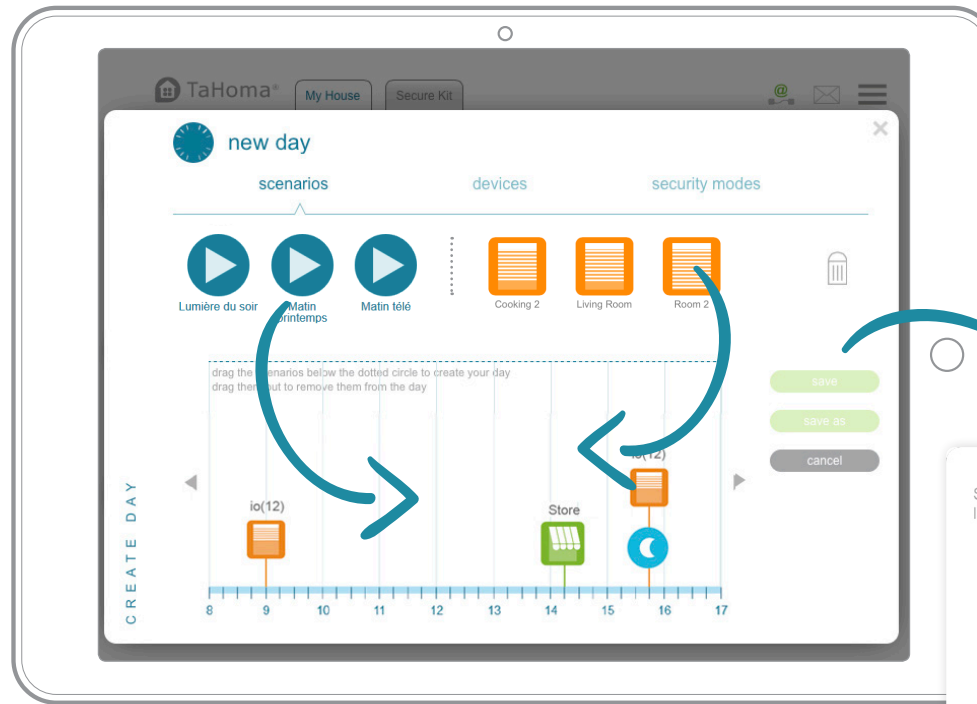

2. Drag your scenarios and/or devices to the time bar.

Select the type of day you create, then give it a label.

work

day off (at home)

holiday (not at home)

Day name:

3. When you have programmed the day, **save the type of day** (work, day off, holiday) **and give it a name.**

# 2.2 Schedule (4/4)

## > Activate a day in the schedule

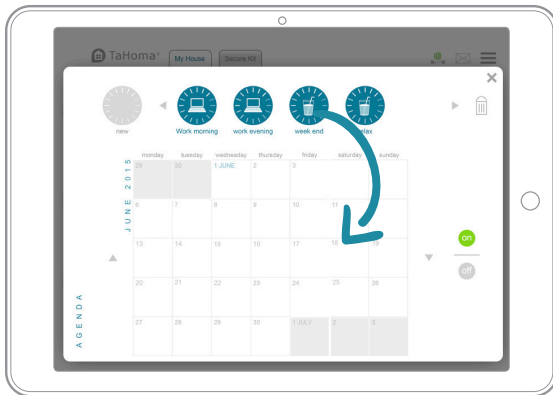

Drag your days to the schedule to programme them.

## > Modify/Delete



Remove a day.



Delete a typical day.



## 2.3 Smart (1/3)



### Your home is interactive

Decide how **your home** and devices should react to the **surrounding environment**.

EXAMPLE

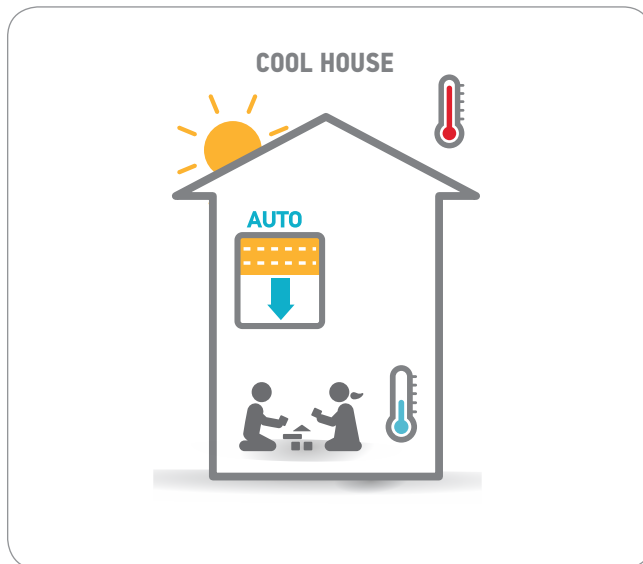

When it's hot in summer:

**The shutters are lowered automatically** based on the temperature sensor reading, to keep your home cool.

Perfect for children!

## 2.3 Smart (2/3)



### > Create a Smart programme

The aim is to create a programme such as: **I WANT ... IF ...**



Click new.  
1. **I WANT...**  
Drag your devices, alerts or scenarios into the box.



2. **IF...**  
Choose which sensors and conditions will start the programme.

3. **Save your programme and give it a name.**

You can:

- add several sensors for more specific conditions (AND/OR).
- add a time condition as well.

### > Activate a Smart programme



Drag your programme into the box to activate it.

When a condition is met, the indicator light turns green. When all the indicator lights are green, the programme starts.



You can deactivate all of the Smart programmes by clicking:

off

# 2.3 Smart (3/3)



## > Modify/Delete

**Deactivate** a Smart programme.



**Delete** a Smart programme.

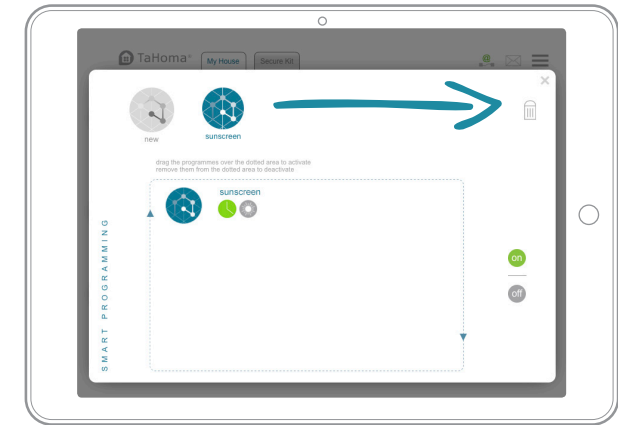

# 3. A few extras (1/6)

## 3.1 The touch-sensor button on the box

(Not available on previous versions of the box)

**Just move your finger and your devices are activated simultaneously.**

Define these actions yourself to meet your needs.  
You can also start your scenarios.  
To configure the touch-sensor button:

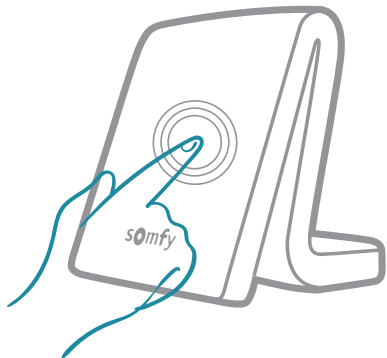

You can also acquire the additional "scenario starter" accessory, which will allow you to configure and start sequences of actions on your devices in the same way.

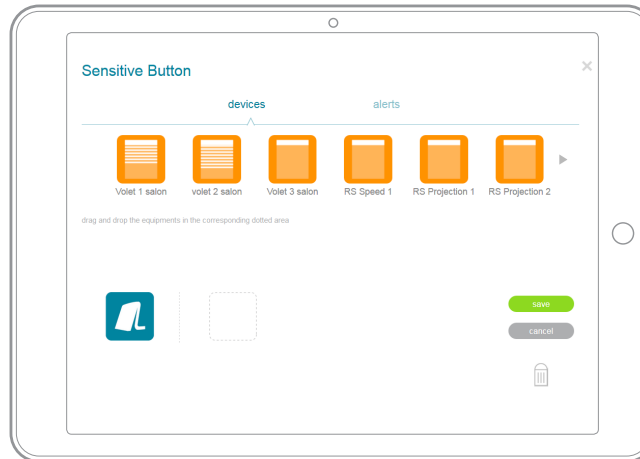

**Drag the elements**  
(shutters, blinds, etc.) that you want to configure **and define the actions** (open, close, etc.).



When you press the touch-sensor button; the indicator light blinks three times. It is possible to cancel the action by pressing the button again within 30 seconds.

# 3. A few extras (2/6)

## 3.2 Dashboard and monitoring

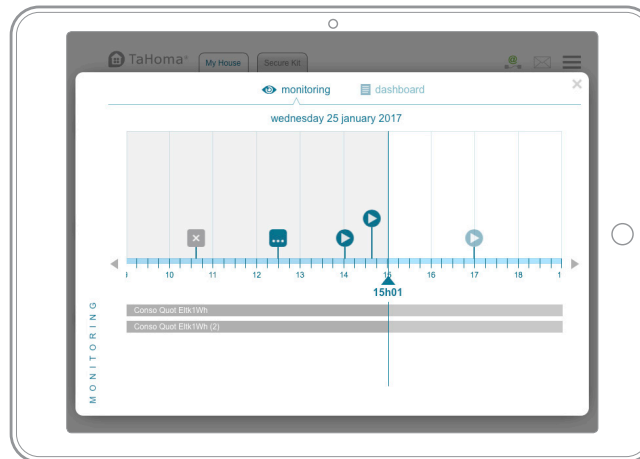
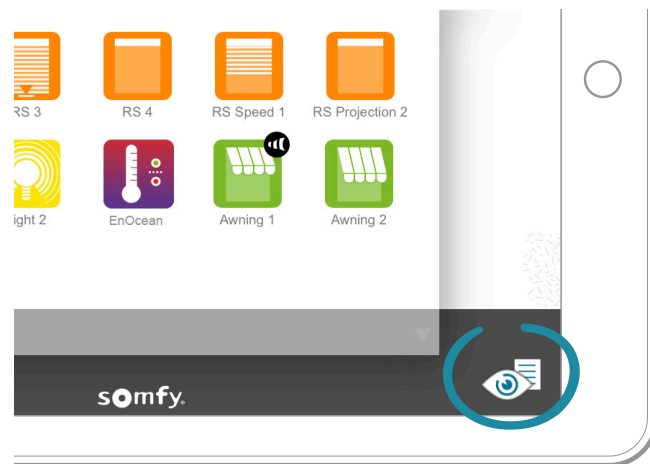

### Monitoring

Monitoring allows you to view all of the actions performed on your devices in chronological order.

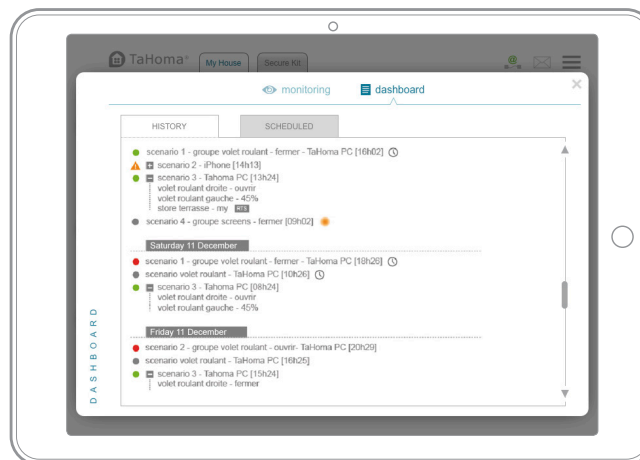

### Dashboard

**History:** shows all of the activities relating to your devices.

**Scheduled:** gives you a list of all the actions scheduled for the day.

# 3. A few extras (3/6)

## 3.3 Your account & your box

Go to the Account section of the main menu:

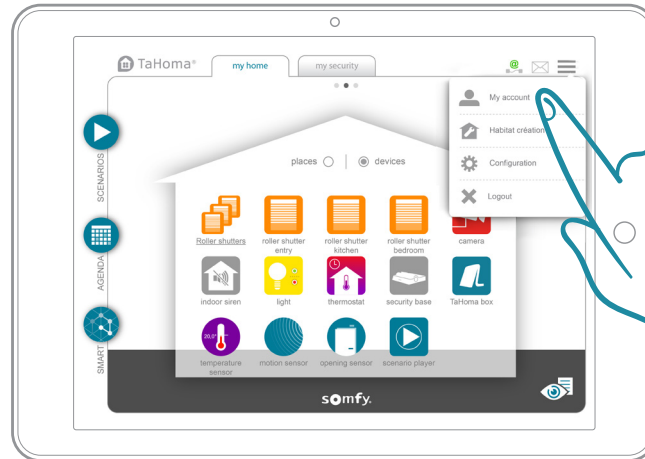

Contains information about:

- **Your box:** PIN, version and activation.
- **Dawn and twilight:** Sunrise and sunset times, to be defined:
  - manually,
  - using your geographic coordinates,
  - using the closest town.

Then:

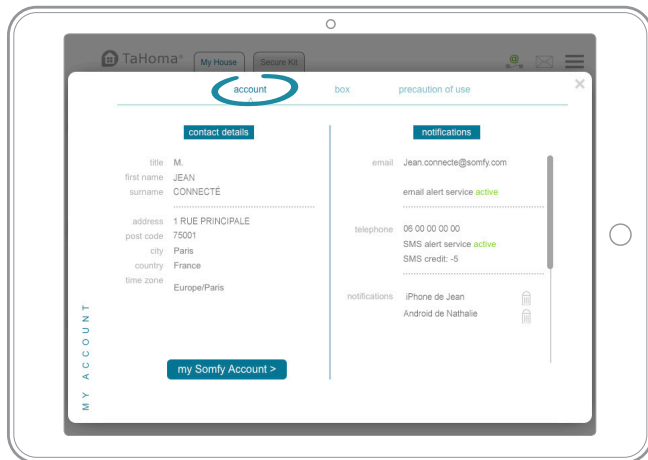

View and edit your account information.

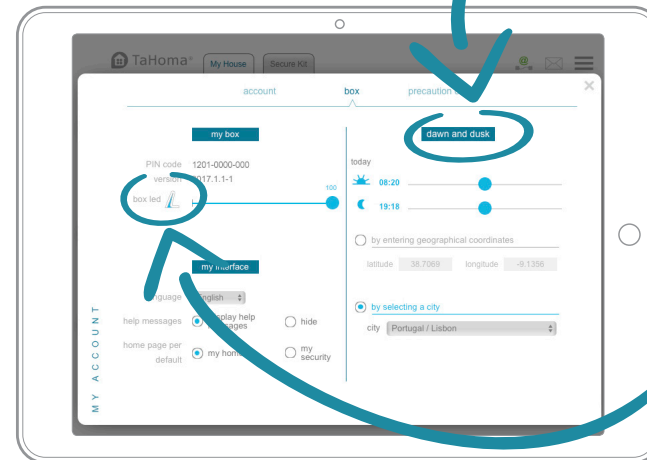

Manage the indicator lights on the box.

# 3. A few extras (4/6)

## 3.2 Default tabs & screens

Your TaHoma® is set up for **Connected alarm** use in its **original configuration**.

The default screens on connection therefore show the **security view** of your home\*.

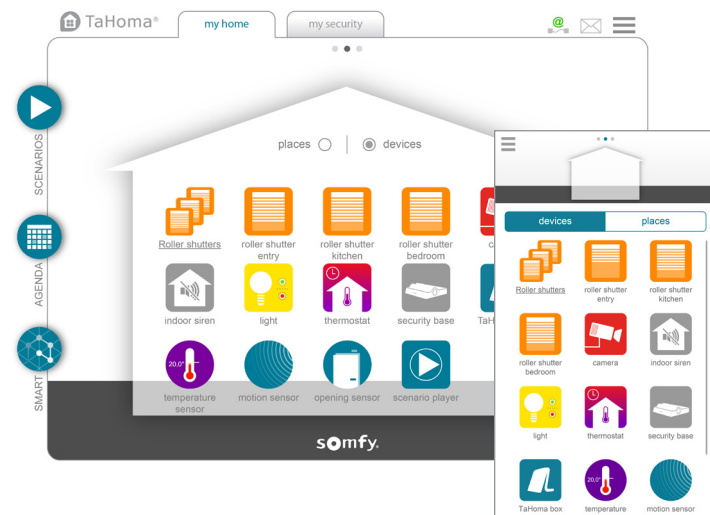

You can modify the default screens if you wish to open the **Home** view each time.

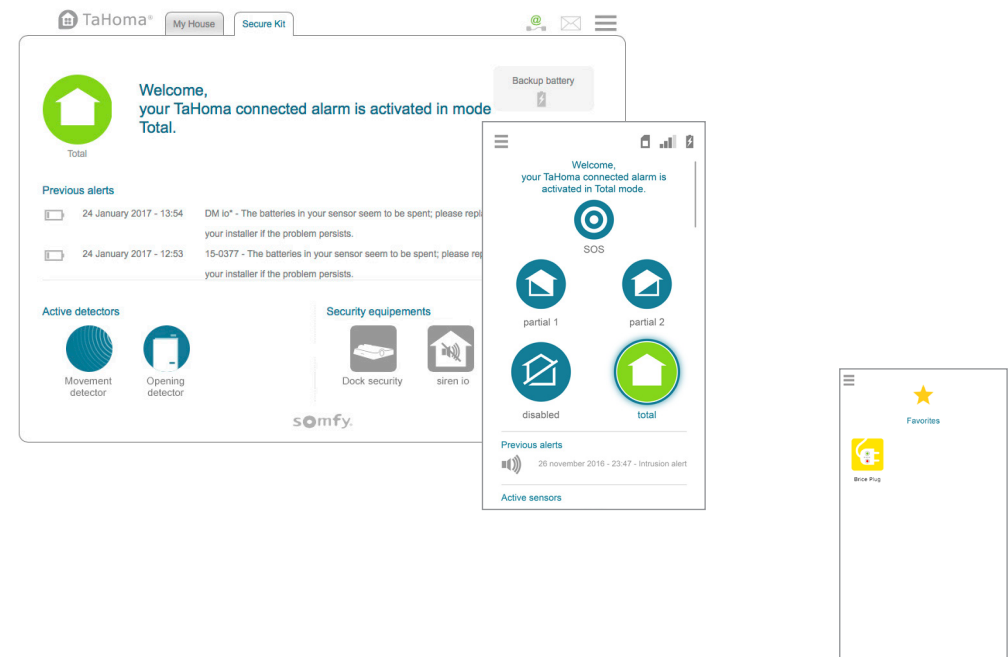

\* Unless you have saved devices as favourites in the smartphone application.

# 3. A few extras (5/6)

To modify the default screens:



Go to the **Account** section of the main menu:



And make the change:

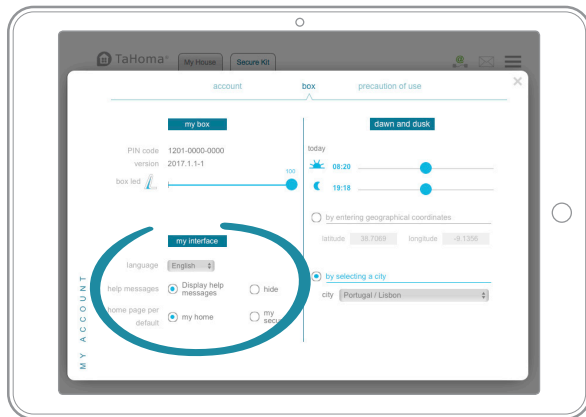

Go to the **Account** section of the main menu:

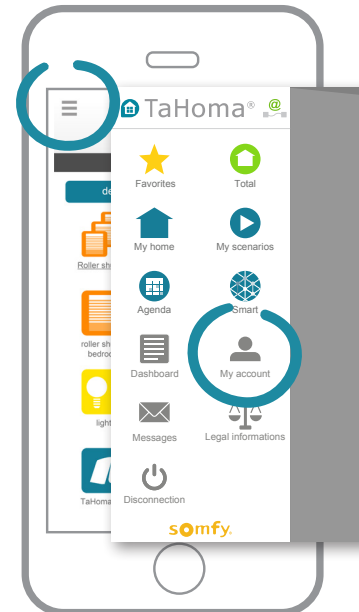

And make the change:

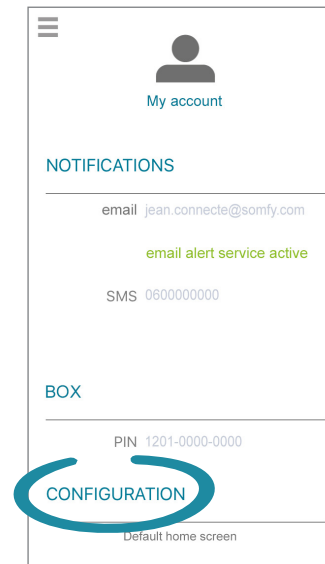



## 3. A few extras (6/6)

### 3.5 For an even more practical security solution



#### Advanced functions of the security remote control





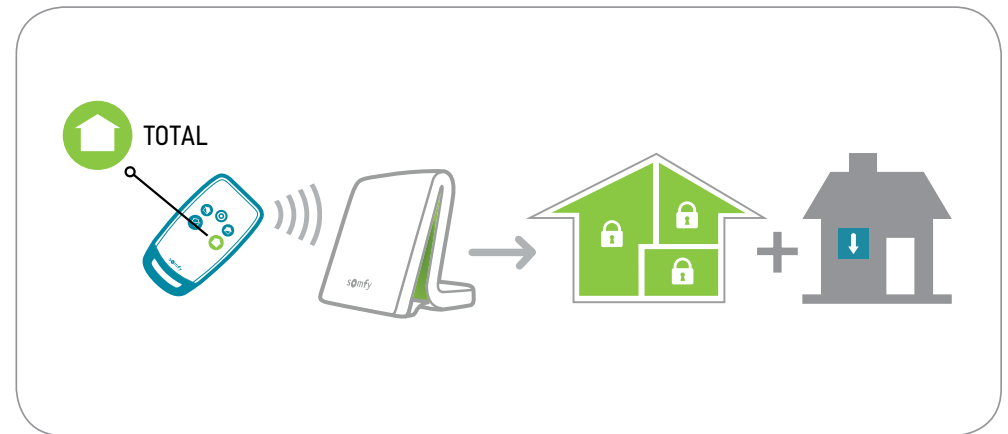

For even more convenient everyday use, the security remote control allows you not only to control the security modes but also to specify the actions performed by the devices connected to TaHoma®.

For example, when you press the Total button on the remote control, security is activated and the shutters close.

For security that more closely matches your needs, these settings are specific to each remote control.



#### To configure actions specific to the remote control:

- Go back to the main interface (see start of this guide).
- Click  → .
- Find the security remote control in the devices (Other Somfy tab).
- Click .
- Then, for each of the three activation modes (    ), drag the required devices and make the desired settings.

The actions to be performed when security  is deactivated can be configured in the mode editing view (see page 14).

# Additional information

# Safety instructions



## TaHoma® box

**Before installing and using this product, please read this guide carefully.**

The installer must comply with standards and legislation in the country in which the product is being installed, and inform his customers of the operating and maintenance conditions for the product.

Any use outside the sphere of application defined by Somfy is forbidden. Doing so would void the warranty and release Somfy of all liability, as would any failure to comply with the instructions given herein.

Never begin installing without first checking the compatibility of this product with the associated devices and accessories.

### Precautions

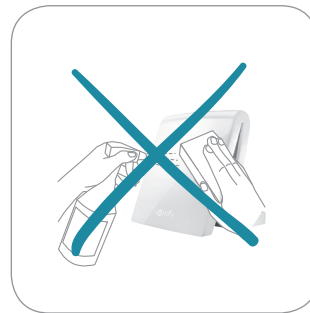
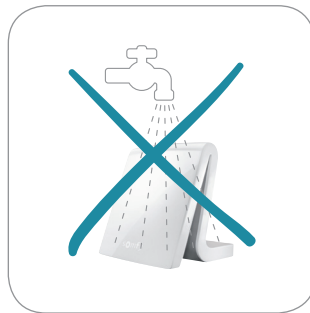

### Pack accessories

Refer to their respective guides.



The product can only be switched off completely by disconnecting the power cable.

# Technical data



## TaHoma® box

|   |   |
|---|---|
| Radio frequency<br>+ Frequency bands and Maximum power used | 433.42 MHz<br>RTS<br>• 433.050 MHz - 434.790 MHz<br>ERP <10 mW<br>868-870 MHz<br>io-homecontrol® tri-band two-way, with LBT (Listen Before Talk)<br>• 868.000 MHz - 868.600 MHz<br>ERP <25 mW<br>• 868.700 MHz - 869.200 MHz<br>ERP <25 mW<br>• 869.700 MHz - 870.000 MHz<br>ERP <25 mW |
| (automatically searches for an unoccupied frequency)        |   |

Protection rating IP20

Operating temperature 0°C to +50°C

Dimensions (l x w x h) 110 x 71.25 x 28.13 mm

Plastic casing ABS

Power supply 12 V DC via 230 V mains adapter

Power consumption during normal operation 5 V continuous 1.75 A

USB interface 5 V DC 2 A max.

## Functions

|  |  |
|--|--|
| Maximum number of devices (all protocols together) | 100  |
| Max. number of io-homecontrol® devices             | 200  |
| Max. number of RTS devices                         | 50   |
| Max. number of RTD devices                         | 50   |
| Max. number of RTDS devices                        | 50   |
| Max. number of controllers                         | 20   |
| Max. number of cameras                             | 5  |
| Max. number of days                                | 40   |
| Max. number of external environments               | 8 (4 on each side of the home)                                   |
| Summer/winter clock change                         | Automatic  |
| Radio range  | 200 m line-of-sight - 20 m through two reinforced concrete walls |
| History  | Dashboard:<br>7-day history                                      |

## Mains adapter

|   |                     |
|---|---------------------|
| Power supply                              | 230 V ~ 50 Hz       |
| Output                                    | 12 V continuous 2 A |
| Power consumption during normal operation | < 2 W               |



## Pack accessories

Refer to their respective guides.



Somfy hereby declares that this product is in compliance with the requirements of Directive 2014/53/EC. The full text of the Declaration of Conformity is available at [www.somfy.com/ce](http://www.somfy.com/ce).

**Somfy SAS**

50 Avenue du Nouveau Monde  
F-74300 CLUSES

[www.somfy.com](http://www.somfy.com)

© 2017 Somfy SAS. All rights reserved. SOMFY and TaHoma® are registered trademarks.  
Apple and the Apple logo are trademarks of Apple Inc., registered in the US and other countries. App Store is a trademark of Apple Inc.  
Google Play is a trademark of Google Inc.  
All other trademarks, names and logos cited may be trademarks or registered trademarks of their respective owners.  
Images for information only.

