

<b>SOMFY</b>	14/03/00	<b>LT 50 SASO TECHNICAL DATA</b>	DMKI - FPTE RANGE 6 LT50SASORange6R0
--------------	----------	----------------------------------	--

Nominal voltage	220 V - 60 Hz
Power supply tolerances	200 - 240V
Thermal time (to reach 115°C)	2,25 minutes
Number of wires of the cable	4
Wire section	0,75 mm <sup>2</sup>
Type of limit switch unit	Quick limit switch
Capacity of the LSU	46 turns
Repeatability	± 5°
System of protection	IP 44
Interface drawings	Screw implantation for LT50 mounting 206810-Wheel interface LT50 206821-Crown interface LT50 206822-Interface drawing star head LT50 and LT50PA/PS 206823-Interface drawing LT50&60 buttons 206817.
Basic crown for tube Ø	50 x 1,5 mm
Temperature working range	Normal use : -10°C to +40°C    Exceptionnal use (20% of the life time not continuous) : -25°C to + 70°C
Noise level	According to SOMFY measures (for information only).Worse value : in load up direction during 10 seconds.

Designation	Nm	rpm	reference	mm	mm	mm	mm	W	A	°C	Brake type	kg	dBA
	Nominal torque	Nominal speed		L1 max.	L2 (*3 mm)	L3 max.	tube	Rated power	Rated current	Thermal tripping		Weight	Noise
503S6	3	38	901209	505	490	513	440	100	0,45	140	sliding	1,72	-
505S6	5	38	901211	525	510	533	460	105	0,5	140	sliding	1,85	-
506A6	6	20	901194	505	490	513	440	70	0,35	140	sliding	1,72	-
508A6	8	20	901195	525	510	533	460	105	0,5	140	sliding	1,85	-
512S6	12	38	901210	605	590	613	540	210	1	150	sliding	2,55	-
514A6	14	20	901196	525	510	533	460	140	0,65	150	sliding	1,95	-
518A6	18	20	901197	555	540	563	490	170	0,8	150	sliding	2,15	-
528R6	28	14	901198	555	540	563	490	175	0,85	150	sliding	2,2	-
538R6	38	14	901199	605	590	613	540	210	1	150	sliding	2,55	57



14/03/00

LT 50 SASO TECHNICAL DATA

RANGE 6

WIRING	Neutral	Blue
	White button	Brown
	Yellow button	Black
	Earth	Green / Yellow

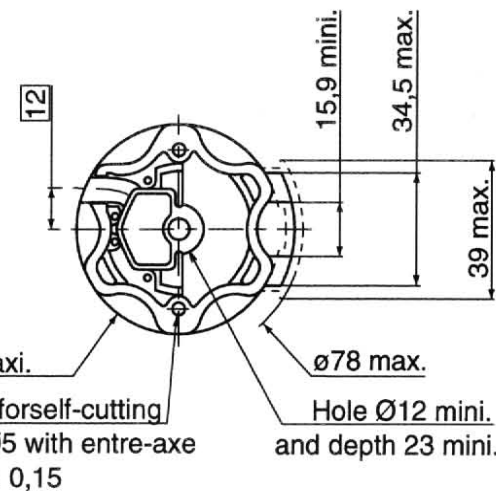
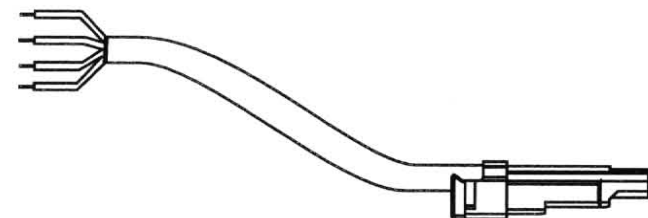
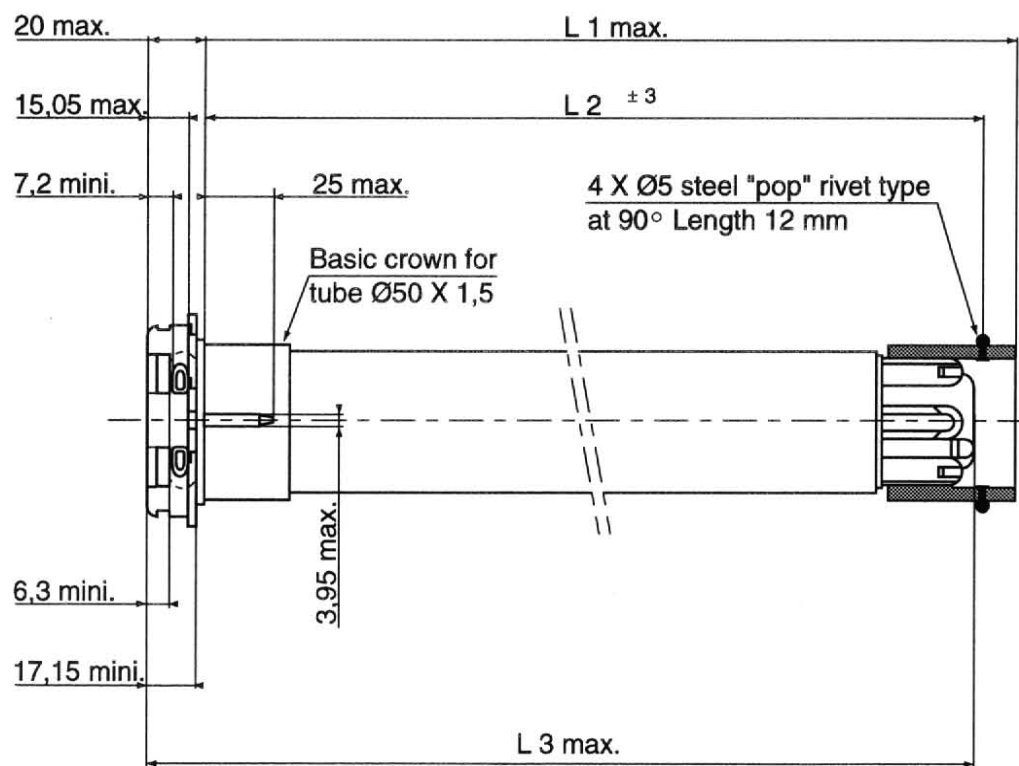

Visa :	DT <i>BSJ</i>	Quality <i>[Signature]</i>	GMD <i>[Signature]</i>
--------	---------------	----------------------------	------------------------